

# Solutions That Move You. Mobile, Modular System . . . Flexible Space

NOW with Microban® antimicrobial product protection inhibiting the growth of mold, mildew, and bacteria.

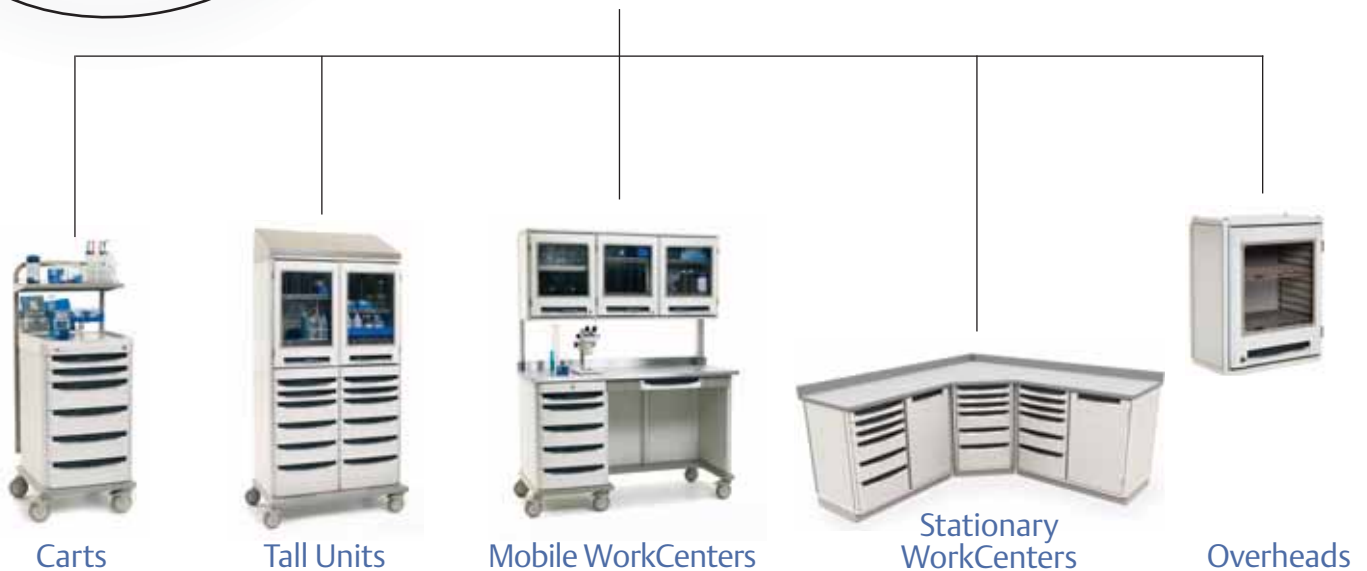

### The Starsys Mobile, Modular System creates flexible space.

No matter what you need — open, closed, short, tall, mobile, stationary elements, preconfigured WorkCenters or carts . . . Starsys has the elements for you.

With Starsys, you choose from an array of modular units to fit the space and work specifications. It's that easy and that flexible.

### Starsys Benefits:

- Facilitates fast, efficient product installation.
- The ability to easily reconfigure lab furniture layout as needs change.
- The ability to quickly reconfigure unit design.
- Flexibility to design a storage solution to meet your exact needs.
- Microban®\* antimicrobial product protection inhibits the growth of mold, mildew, and bacteria keeping the surface area “cleaner between cleanings.”
- Durable, easy-to-clean, polymer enclosures that won't chip, peel, dent or rust ever.
- Rigid aluminum substructure combined with advanced polymers provides a robust stable work environment for even the most sensitive equipment.
- A high level of organization with easy access to supplies.
- Greater storage density in a smaller footprint.

\*MICROBAN® and the MICROBAN® symbol are registered trademarks of the Microban Products Company, Huntersville, NC.

Starsys Carts are built to exact customer specifications, therefore, they are non-cancelable, non-returnable.  
For Starsys pricing information, please contact your local Metro representative.

# Metro® Starsys™ — Reinvent Your Lab!

The mobile, modular Starsys Lab System creates flexible space enhancing lab productivity and space efficiency by empowering you with the ability to easily reconfigure your lab space.



Research Lab . . .

Research Lab, 5 minutes Later . . .

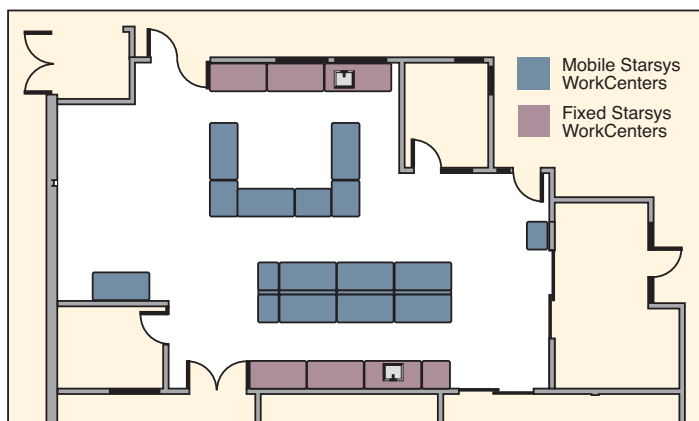
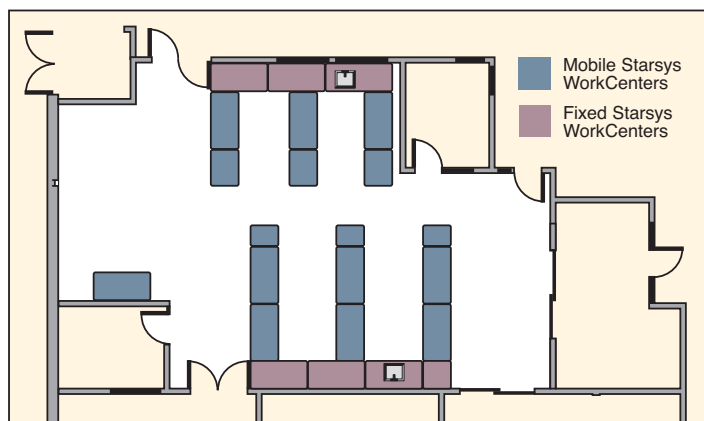

Note: The Starsys System features advanced polymer materials that offer excellent chemical resistance. To obtain a complete Starsys chemical resistance report, please contact your local Metro representative.

To configure a Starsys unit to your exact specifications, please visit [www.metroconfigurator.com](http://www.metroconfigurator.com)

# Solutions That Move You. Mobile, Modular, Metro.



Microban® antimicrobial protection inhibits the growth of stain and odor-causing bacteria on Starsys, keeping the surface areas “cleaner between cleanings.”

Easy to clean advanced polymer material is a marked improvement over traditional metal carts: won't dent, chip, rust, flake or corrode.

Interchangeable 3", 6" and 9" (76, 152 and 230mm) drawers with removable totes can be fully extended for easy access.

Color-coded drawer pulls are available in an array of choices to fit any system or decor.

Label holders available to quickly identify drawer contents.

Each drawer face has a 1/2 x 18 3/8" polished area allowing for secure adhesion of DYMO and Zebra labels (not supplied by Metro).



The convenient overbridge can be fitted with a wide selection of baskets, shelves, and bins to keep necessary items within reach.

Swing-out Side Storage units increase work surface up to 135%.

Side storage allows easy customization of a wide variety of accessories.

5" (127mm) polymer total-lock casters provide a stable work station when locked and smooth rolling cart when not.



## Starsys Carts

Starsys provides a complete system of enclosed carts in a wide variety of heights and system widths. When mobility is a key part of your storage needs, Starsys carts provide a broad selection of unique solutions. This modular system approach allows you to create a cart to meet your exact needs.

### Starsys cart widths and depths:

The Starsys cart system is built upon a square module. Multiplying this storage module results in system widths of single 22 3/4" (578mm), double 42 1/2" (1080mm) and triple widths 62 1/2" (1588mm). Depth on all carts is 24.9" (632mm).

### Starsys cart heights:

Starsys carts are available in the following working heights: 36" (907mm), 39" (983mm), 42" (1060mm), 45" (1136mm) and 48" (1212mm).

## General Overview:

Starsys carts feature 5" (127mm) polymer swivel casters. The front two casters have a total-lock toe brake (locks both the wheel and the horn).

Starsys carts feature a smooth polymer top/worksurface. If chemical resistance is a concern or heavy equipment is likely to be placed on the top of the cart, Starsys Mobile WorkCenters may be a more appropriate product selection.

An extended mobile base is required when Heavy-Duty drawers, Active Level shelving or quikSLOT shelving is specified in a Starsys configuration. The extended mobile base adds an additional 3" (76mm) to the overall depth of the cart. The extended base combines additional counter weights with a deeper footprint to reduce any chance of overbalance when active level shelving is fully extended.

Starsys Carts are built to exact customer specifications, therefore, they are non-cancelable, non-returnable.

For Starsys pricing information, please contact your local Metro representative.

See page 200 for specification details.

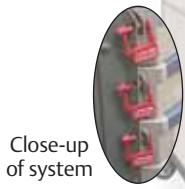

Close-up of system



Emergency Response  
Cat. No. **SXRS40CM1**



General Supply  
Cat. No. **SXRSISO**



Gowning Storage  
Cat. No. **SXRSMDSRG**



Fume Hood Storage  
Cat. No. **SXRSDRS**



Personal Protective Equipment  
Cat. No. **SXRS43CM1**



Validation  
Cat. No. **SXRS43CM3**



General Supply  
Cat. No. **SXRS43CM4**



General Supply  
Cat. No. **SXRS43CM6**



LAR Surgery  
Cat. No. **SXRSANES**



Computer  
Cat. No. **SXRSBED**



LAR Investigator  
Cat. No. **SXRSDCMED**



LAR Procedure  
Cat. No. **SXRSARTH**



Computer Ready Cart  
Cat. No. **SXRCOMPBED**



LAR I.V. Therapy  
Cat. No. **SXRSIV**

To configure a Starsys unit to your exact specifications, please visit [www.metroconfigurator.com](http://www.metroconfigurator.com)

See page 200 for specification details.



LAR Anesthesia  
Cat. No. **SXRSUDOSE**



LAR Imaging  
Cat. No. **SXRSTRAMA**



Cold Room/Buffer Cart  
Cat. No. **SXRD43CM3**



LAR Secure Transport  
Cat. No. **SXRD43CM4**



Biomedical  
Cat. No. **SXRSBIO**



LAR Euthanize  
Cat. No. **SXRSCCU**



LAR Procedure  
Cat. No. **SXRSCAST**



SXR53310L



SXR53210L

Basic Single Wide, Locking Carts

| (in.)  | (mm)          | Drawer Configuration    | Cat. No.         |
|--|---------------|-------------------------|------------------|
| 24 <sup>7</sup> / <sub>8</sub> x22 <sup>3</sup> / <sub>4</sub> x41 <sup>3</sup> / <sub>4</sub> | 1061x578x1061 | 1-3", 3-6", 1-9", 0-12" | <b>SXRS1310L</b> |
| 24 <sup>7</sup> / <sub>8</sub> x22 <sup>3</sup> / <sub>4</sub> x41 <sup>3</sup> / <sub>4</sub> | 1061x578x1061 | 3-3", 2-6", 1-9", 0-12" | <b>SXRS3210L</b> |
| 24 <sup>7</sup> / <sub>8</sub> x22 <sup>3</sup> / <sub>4</sub> x41 <sup>3</sup> / <sub>4</sub> | 1061x578x1061 | 5-3", 1-6", 1-9", 0-12" | <b>SXRS5110L</b> |
| 24 <sup>7</sup> / <sub>8</sub> x22 <sup>3</sup> / <sub>4</sub> x44 <sup>3</sup> / <sub>4</sub> | 1137x578x1137 | 1-3", 2-6", 2-9", 0-12" | <b>SXRS1220L</b> |
| 24 <sup>7</sup> / <sub>8</sub> x22 <sup>3</sup> / <sub>4</sub> x44 <sup>3</sup> / <sub>4</sub> | 1137x578x1137 | 4-3", 2-6", 1-9", 0-12" | <b>SXRS4210L</b> |
| 24 <sup>7</sup> / <sub>8</sub> x22 <sup>3</sup> / <sub>4</sub> x44 <sup>3</sup> / <sub>4</sub> | 1137x578x1137 | 6-3", 1-6", 1-9", 0-12" | <b>SXRS6110L</b> |
| 24 <sup>7</sup> / <sub>8</sub> x22 <sup>3</sup> / <sub>4</sub> x47 <sup>3</sup> / <sub>4</sub> | 1213x578x1213 | 0-3", 3-6", 2-9", 0-12" | <b>SXRS0320L</b> |
| 24 <sup>7</sup> / <sub>8</sub> x22 <sup>3</sup> / <sub>4</sub> x47 <sup>3</sup> / <sub>4</sub> | 1213x578x1213 | 2-3", 2-6", 2-9", 0-12" | <b>SXRS2220L</b> |
| 24 <sup>7</sup> / <sub>8</sub> x22 <sup>3</sup> / <sub>4</sub> x47 <sup>3</sup> / <sub>4</sub> | 1213x578x1213 | 3-3", 3-6", 1-9", 0-12" | <b>SXRS3310L</b> |

Drawer Pulls (one required per drawer) To specify color for drawer pull, order following catalog numbers for each drawer:

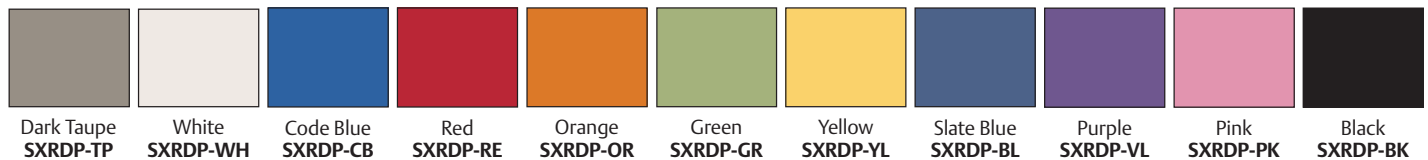

Dark Taupe **SXRDP-TP**    White **SXRDP-WH**    Code Blue **SXRDP-CB**    Red **SXRDP-RE**    Orange **SXRDP-OR**    Green **SXRDP-GR**    Yellow **SXRDP-YL**    Slate Blue **SXRDP-BL**    Purple **SXRDP-VL**    Pink **SXRDP-PK**    Black **SXRDP-BK**

Starsys Carts are built to exact customer specifications, therefore, they are non-cancelable, non-returnable.

For Starsys pricing information, please contact your local Metro representative.

## Starsys Carts — Security Options

### Mechanical Keylocks

The new M300 Series Keylocks have an "Ignition-Style" design to protect keys from bending or breaking. Mechanical keylocks are a good choice for all kinds of applications and work on all types of units and accessories — carts, cabinets, drawers, doors and wall cabinets. They are available as primary locks or as backups for other types of locking systems. Each lock includes a set of two keys. Extra keys available upon request.



M300 Series Keylock



EPBL Lock

### Electronic Push Button Locks ("EPBL" Locks)

The "EPBL" Lock is a simple push-button, battery-operated 4-digit code lock with a 10-digit push button face and 10-user programmable PIN numbers. Correctly entering a 4-digit code will allow a simple lock latch to be turned for access. Master, Sub-Master, User and Single Use functions. Power: (2) AAA Batteries.

### Electronic Touchpad Locking System

Our most advanced full-feature keyless electronic drawer locking system designed for use on single-, double- and triple-wide carts in heights from 36" to 48" tall.

Features:

- 2,000 User/Supervisor Codes
- Auto-relock with Motion Sensors
- USB Port for Audit Access
- Proximity & Magnetic Card Reader Options
- User Management/Audit Trail Software option
- Multiple Bay Security

### Touchpads & Options

| Description                                      | Cat. No.     |
|--|--------------|
| Keyless Entry Touchpad — Single Bay Locking      | SXRTP-varies |
| Keyless Entry Touchpad — Double Bay Locking      | SXRTP-varies |
| Keyless Entry Touchpad — Triple Bay Locking      | SXRTP-111    |
| User Management/Audit Trail Software             | FL421        |
| Charger/Voltage Adapter (for outside N. America) | SXR-INTLCHGR |
| Proximity Reader                                 | SXR-PRXRDR   |
| Proximity User Card                              | SXR-UPROXCRD |
| Proximity Key Ring Tag                           | SXR-PROXTAG  |
| Magstripe Reader                                 | SXR-MAGRDR   |



### Hinged Push-Button Lockbars

These versatile push button lockbars can be used to lock both drawers and doors. Because the push button mechanism is purely mechanical, no wiring, electronic or batteries are required. Each lockbar includes a backup M300 series keylock, 2 keys, and a passive security locktab (security seals ordered separately: LEC9900A = Bag of 100).

For Factory-Assembled Units

| Description                 | Left Mounted<br>Cat. No. | Right Mounted<br>Cat. No. |
|-----------------------------|--------------------------|---------------------------|
| 24"H (610mm) Hinged Lockbar | SXRPBL24L                | SXRPBL24R                 |
| 27"H (686mm) Hinged Lockbar | SXRPBL27L                | SXRPGL27R                 |
| 30"H (762mm) Hinged Lockbar | SXRPBL30L                | SXRPBL30R                 |
| 33"H (839mm) Hinged Lockbar | SXRPBL33L                | SXRPBL33R                 |
| 36"H (914mm) Hinged Lockbar | SXRPBL36L                | SXRPBL36R                 |

For field retrofit of above key locking bars, add suffix -KD to above part numbers.



Tamper-Evident Locks



Hinged Lockbar

### Tamper-Evident (Passive Security) Locks

Provides passive security for each drawer individually. Quick visual confirmation of broken seals indicates which drawers have been opened. Includes factory-installed lockbar, drawer locktabs permanently riveted to each drawer, and 100 security seals.

To configure a Starsys unit to your exact specifications, please visit [www.metroconfigurator.com](http://www.metroconfigurator.com)



Removable drawer totes allow for exchange or convenient access outside of cart

Polymer Drawers (Drawer pull required — see selection below)

| Description             | Inside Dimensions (Height/Width/Length) (in.)  | Non-Locking Cat. No. | Locking Cat. No. |
|-------------------------|--|----------------------|------------------|
| 3" (76mm) SW Drawer     | 2 <sup>3</sup> / <sub>8</sub> x16 <sup>3</sup> / <sub>8</sub> x15 <sup>7</sup> / <sub>8</sub>  | <b>SXRS3</b>         | <b>SXRS3-LK</b>  |
| 4.5" (114mm) SW Drawer  | 37/8x16 <sup>3</sup> / <sub>8</sub> x15 <sup>7</sup> / <sub>8</sub>                            | <b>SXRS4.5</b>       |                  |
| 6" (152mm) SW Drawer    | 5 <sup>3</sup> / <sub>8</sub> x16 <sup>1</sup> / <sub>4</sub> x15 <sup>3</sup> / <sub>4</sub>  | <b>SXRS6</b>         | <b>SXRS6-LK</b>  |
| 7.5" (191mm) SW Drawer  | 6 <sup>7</sup> / <sub>8</sub> x16 <sup>1</sup> / <sub>4</sub> x15 <sup>3</sup> / <sub>4</sub>  | <b>SXRS7.5</b>       |                  |
| 9" (230mm) SW Drawer    | 8 <sup>3</sup> / <sub>8</sub> x16 <sup>1</sup> / <sub>4</sub> x15 <sup>3</sup> / <sub>4</sub>  | <b>SXRS9</b>         | <b>SXRS9-LK</b>  |
| 10.5" (267mm) SW Drawer | 9 <sup>7</sup> / <sub>8</sub> x16 <sup>1</sup> / <sub>4</sub> x15 <sup>3</sup> / <sub>4</sub>  | <b>SXRS10.5</b>      |                  |
| 12" (305mm) SW Drawer   | 11 <sup>3</sup> / <sub>8</sub> x16 <sup>1</sup> / <sub>4</sub> x15 <sup>3</sup> / <sub>4</sub> | <b>SXRS12</b>        |                  |

Drawer Pulls (one required per drawer) To specify color for drawer pull, order following catalog numbers for each drawer:

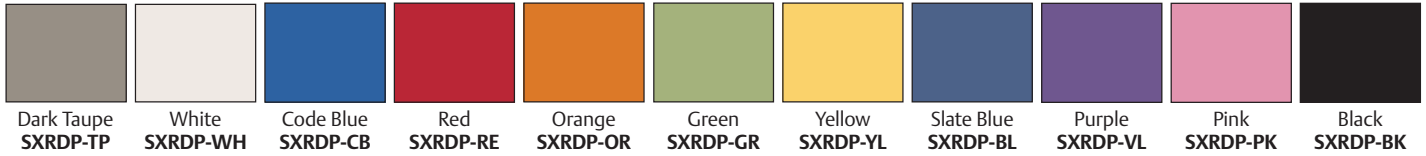

SXRLABKIT

Drawer Label Holders

| Description                    | Height/Length in.       | Cat. No.         |
|--------------------------------|-------------------------|------------------|
| Label Kits (10 Pieces Per Kit) | 3/4" X 11" (19 x 279mm) | <b>SXRLABKIT</b> |



Drawer dividers are available to organize your supplies for easy access.

Drawer Accessories for Drawers and Full Extension Totes

Drawer Divider Kits

| Description  | Product Detail (Qty.) in. | Cat. No.        |
|--|---------------------------|-----------------|
| 3" (76mm) Drawer Divider Kit                         | (2) 16.8 & (6) 5          | <b>SXR3DIV</b>  |
| 3" (76mm) Drawer Short Dividers                      | (3) 5                     | <b>SXR3SDIV</b> |
| 3" (76mm) Drawer Long Dividers                       | (2) 16.8                  | <b>SXR3LDIV</b> |
| Egg Crate Style 3" (76mm) Drawer Divider Kit         | (5) 16.8 & (10) 8         | <b>SXR3DVR</b>  |
| 6" (76mm) Drawer Divider Kit                         | (2) 16.8 & (6) 5          | <b>SXR6DIV</b>  |
| 6" (76mm) Drawer Short Dividers                      | (3) 5                     | <b>SXR6SDIV</b> |
| 6" (76mm) Drawer Long Dividers                       | (2) 16.8                  | <b>SXR6LDIV</b> |
| Egg Crate Style 6"/9" (152/230mm) Drawer Divider Kit | (5) 16.8 & (10) 8         | <b>SXR6DVR</b>  |



Drawer Totes

Additional Starsys Totes — Totes provide complete containment for smaller items.

| Description            | Inside Dimensions (Height/Width/Length) (in.) (mm)  | Non-Locking Cat. No. | Locking Cat. No.   |
|------------------------|---|----------------------|--------------------|
| 3" (76mm) Drawer Tote  | 2 <sup>3</sup> / <sub>4</sub> x18 <sup>1</sup> / <sub>4</sub> x17 <sup>1</sup> / <sub>2</sub> 70x464x445  | <b>SXR3TOTE</b>      | <b>SXR3-LKTOTE</b> |
| 6" (152mm) Drawer Tote | 5 <sup>3</sup> / <sub>4</sub> x18 <sup>1</sup> / <sub>4</sub> x17 <sup>1</sup> / <sub>2</sub> 146x464x445 | <b>SXR6TOTE</b>      | <b>SXR6-LKTOTE</b> |
| 9" (229mm) Drawer Tote | 8 <sup>1</sup> / <sub>2</sub> x18 <sup>1</sup> / <sub>4</sub> x17 <sup>1</sup> / <sub>2</sub> 216x464x445 | <b>SXR9TOTE</b>      | <b>SXR9-LKTOTE</b> |

Starsys Carts are built to exact customer specifications, therefore, they are non-cancelable, non-returnable.

For Starsys pricing information, please contact your local Metro representative.

Accessories for Units with Slotted Polymer Inner Panels

Polymer Shelves

| Cat. No.             | Description   |
|----------------------|---|
| <b>SXRPOLY</b>       | Single Wide Polymer Shelf   |
| <b>SXRPOLYDIV</b>    | Poly Shelf Divider Kit (Includes 2 Divider Rails, 4 Dividers)                   |
| <b>SXRSF-VSHFDIV</b> | Single Wide Vertical Shelf Divider Kit (w/(2) brackets & (2) vertical dividers) |
| <b>SXRDF-VSHFDIV</b> | Double Wide Vertical Shelf Divider Kit (w/(2) brackets & (2) vertical dividers) |
| <b>SXRFVDIV-1</b>    | Extra Vertical Shelf Divider  |



Polymer shelves are easy to clean and reposition.

Suture Storage

| Cat. No.         | Description           |
|------------------|-----------------------|
| <b>SXRSUTURE</b> | Suture Storage Module |



Suture Storage

Full-Extension Totes/Dividers

| Cat. No.        | Description   |
|-----------------|---|
| <b>SXRFTOT3</b> | 3" Full Extension Tote/Frame Assembly                                 |
| <b>SXRFTOT6</b> | 6" Full Extension Tote/Frame Assembly                                 |
| <b>SXRFTOT9</b> | 9" Full Extension Tote/Frame Assembly                                 |
| <b>SXR3DIV</b>  | 3" Tote Divider Kit (Includes (2) Long Dividers & (6) Short Dividers) |
| <b>SXR3SDIV</b> | 3" Short Divider Kit (3-Pack)   |
| <b>SXR3LDIV</b> | 3" Long Divider Kit (2-Pack)  |
| <b>SXR6DIV</b>  | 6" Tote Divider Kit (Includes (2) Long Dividers & (6) Short Dividers) |
| <b>SXR6SDIV</b> | 6" Short Divider Kit (3-Pack)   |
| <b>SXR6LDIV</b> | 6" Long Divider Kit (2-Pack)  |
| <b>SXR3RDVR</b> | 3" Eggcrate Style Tote Divider Kit                                    |
| <b>SXR6RDVR</b> | 6" Eggcrate Style Tote Divider Kit                                    |



Full Extension Tote and Basket

Full-Extension Baskets/Dividers

| Cat. No.          | Description                               |
|-------------------|---|
| <b>SXRFBSK3</b>   | 3" Full Extension Basket/Frame Assembly   |
| <b>SXRFBSK7</b>   | 7.5" Full Extension Basket/Frame Assembly |
| <b>SXRFB3SDIV</b> | 3" Short Basket Dividers (3-Pack)         |
| <b>SXRFB3LDIV</b> | 3" Long Basket Dividers (2-Pack)          |
| <b>SXRFB7SDIV</b> | 7.5" Short Basket Dividers (3-Pack)       |
| <b>SXRFB7LDIV</b> | 7.5" Long Basket Dividers (2-Pack)        |



Baskets

Additional Baskets

| Cat. No.     | Description          | Color | Qty. | Length/Height           |                 |
|--------------|----------------------|-------|------|-------------------------|-----------------|
|              |                      |       |      | (in.)                   | (mm)            |
| <b>BSKT3</b> | 3" (76mm) H. Basket  | White | 6    | 3 1/4 x 20 3/4 x 16 3/4 | 83 x 527 x 425  |
| <b>BSKT7</b> | 7" (178mm) H. Basket | White | 6    | 7 1/4 x 20 3/4 x 16 3/4 | 184 x 527 x 425 |

Wire grid space: 1 1/8" x 1 1/8" (29 x 29mm)

To configure a Starsys unit to your exact specifications, please visit [www.metroconfigurator.com](http://www.metroconfigurator.com)



4 Level Cassette



Bins



Double-Wide, Double Sided Cassette Transfer Cart  
Cat. No. SXR43TRAN  
(shown with cassettes and bins, sold separately, see above)

Components — Polymer

| Description   | No. of Bins Per Level | Overall Dimensions   |                          | Cat. No.  |
|---|-----------------------|--|--------------------------|-----------|
|   |                       | (in.)  | Height/Width/Length (mm) |           |
| <b>Cassettes and Bins</b>                                 |                       |  |                          |           |
| 1 Level Cassette Body                                     |                       | 5 <sup>15</sup> / <sub>16</sub> X11 <sup>3</sup> / <sub>4</sub> X19 <sup>3</sup> / <sub>8</sub>  | 151x298x492              | SXRCASB1  |
| 2 Level Cassette Body                                     |                       | 8 <sup>15</sup> / <sub>16</sub> X11 <sup>3</sup> / <sub>4</sub> X19 <sup>3</sup> / <sub>8</sub>  | 277x298x492              | SXRCASB2  |
| 3 Level Cassette Body                                     |                       | 11 <sup>15</sup> / <sub>16</sub> X11 <sup>3</sup> / <sub>4</sub> X19 <sup>3</sup> / <sub>8</sub> | 303x298x492              | SXRCASB3  |
| 4 Level Cassette Body                                     |                       | 14 <sup>15</sup> / <sub>16</sub> X11 <sup>3</sup> / <sub>4</sub> X19 <sup>3</sup> / <sub>8</sub> | 379x298x492              | SXRCASB4  |
| 5 Level Cassette Body                                     |                       | 17 <sup>15</sup> / <sub>16</sub> X11 <sup>3</sup> / <sub>4</sub> X19 <sup>3</sup> / <sub>8</sub> | 456x298x492              | SXRCASB5  |
| 3" (76mm) wide Cassette Bin                               | 6                     | 2 <sup>9</sup> / <sub>16</sub> X11 <sup>15</sup> / <sub>16</sub> X2 <sup>1</sup> / <sub>16</sub> | 65x303x68                | SXRBINSB3 |
| 4 <sup>1</sup> / <sub>2</sub> " (114mm) wide Cassette Bin | 4                     | 2 <sup>9</sup> / <sub>16</sub> X11 <sup>15</sup> / <sub>16</sub> X4 <sup>1</sup> / <sub>16</sub> | 65x303x103               | SXRBINSB4 |
| 6" (152mm) wide Cassette Bin                              | 3                     | 2 <sup>9</sup> / <sub>16</sub> X11 <sup>15</sup> / <sub>16</sub> X5 <sup>1</sup> / <sub>2</sub>  | 65x303x140               | SXRBINSB6 |
| 8" (203mm) wide Cassette Bin                              | 2                     | 2 <sup>9</sup> / <sub>16</sub> X11 <sup>15</sup> / <sub>16</sub> X8                              | 65x303x203               | SXRBINSB8 |

Note: Bins are shipped with one ID card.

| Description   | Cat. No.     |
|---|--------------|
| <b>Bin Accessories</b>  |              |
| Cassette Bin Divider Kit (20 dividers)  | SXRBINDIV    |
| Cassette Label Kit (includes label strips in Mauve, Slate Blue and Jade for identification of bins) | SXRCASLAB    |
| Cassette Bin Labels (5 sheets of Slate Blue bin labels — 18 of each size per sheet)                 | SXRBINLAB-BL |
| Cassette Bin Labels (5 sheets of Jade bin labels — 18 of each size per sheet)                       | SXRBINLAB-GR |
| Cassette Bin Labels (5 sheets of Mauve bin labels — 18 of each size per sheet)                      | SXRBINLAB-RD |

SXRBINDIV divides up to 4 bins.

SXRCASLAB includes 3 sheets of labels. One sheet per color. Each sheet contains 18 labels for each size bin. It also includes 18 patient ID bin cards for each size bin and 4 cassette ID labels.

Cassette Transfer Carts

| Description                       | (in.)   | Overall Dimensions       |                                | Inside Height |        | Approx. Pkd. Wt. |  | Cat. No.   |
|-----------------------------------|---|--------------------------|--------------------------------|---------------|--------|------------------|--|------------|
|                                   |   | Height/Width/Length (mm) | (in.)                          | (mm)          | (lbs.) | (kg)             |  |            |
| <b>Single-Wide, Double-Sided*</b> |   |                          |                                |               |        |                  |  |            |
| 40" (1016mm) Single               | 39 <sup>3</sup> / <sub>4</sub> X24 <sup>7</sup> / <sub>8</sub> X22 <sup>1</sup> / <sub>16</sub> | 1010x632x576             | 30 <sup>1</sup> / <sub>4</sub> | 768           | 150    | 68               |  | SXRS40TRAN |
| 43" (1092mm) Single               | 42 <sup>3</sup> / <sub>4</sub> X24 <sup>7</sup> / <sub>8</sub> X22 <sup>1</sup> / <sub>16</sub> | 1086x632x576             | 33 <sup>1</sup> / <sub>4</sub> | 845           | 150    | 68               |  | SXRS43TRAN |
| 46" (1168mm) Single               | 45 <sup>3</sup> / <sub>4</sub> X24 <sup>7</sup> / <sub>8</sub> X22 <sup>1</sup> / <sub>16</sub> | 1162x632x576             | 36 <sup>1</sup> / <sub>4</sub> | 921           | 157    | 71               |  | SXRS46TRAN |
| <b>Double-Wide, Double Sided*</b> |   |                          |                                |               |        |                  |  |            |
| 40" (1016mm) Double               | 39 <sup>3</sup> / <sub>4</sub> X24 <sup>7</sup> / <sub>8</sub> X42 <sup>1</sup> / <sub>2</sub>  | 1010x632x1080            | 30 <sup>1</sup> / <sub>4</sub> | 768           | 170    | 77               |  | SXRD40TRAN |
| 43" (1092mm) Double               | 42 <sup>3</sup> / <sub>4</sub> X24 <sup>7</sup> / <sub>8</sub> X42 <sup>1</sup> / <sub>2</sub>  | 1086x632x1080            | 33 <sup>1</sup> / <sub>4</sub> | 845           | 176    | 80               |  | SXRD43TRAN |
| 46" (1168mm) Double               | 45 <sup>3</sup> / <sub>4</sub> X24 <sup>7</sup> / <sub>8</sub> X42 <sup>1</sup> / <sub>2</sub>  | 1162x632x1080            | 36 <sup>1</sup> / <sub>4</sub> | 921           | 181    | 82               |  | SXRD46TRAN |

\*Cassette storage available on both front and back of cart.

Starsys™ Single Bin Access Cassette System

Cassette shown in "Single Bin Access" Mode



Detail of Turn Latch

Cassette shown in "Full Level" Mode



Starsys Carts are built to exact customer specifications, therefore, they are non-cancelable, non-returnable.  
For Starsys pricing information, please contact your local Metro representative.

## Shelves & Accessories for Units with qwikSLOT Inserts

### Wire Shelves

| Cat. No.          | Description   |
|-------------------|---|
| <b>SXRSWQ</b>     | Single Wide QS Wire Shelf                                 |
| <b>SXRSWAR</b>    | Single Wide Full Extension Wire Shelf (Right Thumb Latch) |
| <b>SXRSWAL</b>    | Single Wide Full Extension Wire Shelf (Left Thumb Latch)  |
| <b>SXRDWQ</b>     | Double Wide QS Wire Shelf                                 |
| <b>SXRDWAR</b>    | Double Wide Full Extension Wire Shelf (Right Thumb Latch) |
| <b>SXRDWAL</b>    | Double Wide Full Extension Wire Shelf (Left Thumb Latch)  |
| <b>2148CI-4</b>   | Clear Inlays for Wire Shelves (4-Pk)                      |
| <b>9990P7</b>     | Label Holder for Single Wide Wire Shelf                   |
| <b>9990P8</b>     | Label Holder for Double Wide Wire Shelf                   |
| <b>SXRSLDG</b>    | 4"H Wire Shelf Ledge                                      |
| <b>SXRSLFDIV</b>  | 4"H Wire Shelf Divider                                    |
| <b>SXRSLFDIV8</b> | 8"H Wire Shelf Divider                                    |



SXRSLDG Ledge

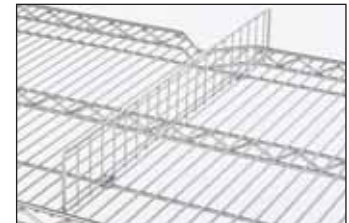

SXRSLFDIV

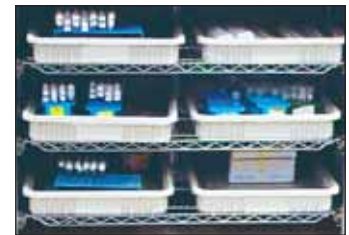

Metro Totes

### Metro Totes

| Outside Dimensions<br>(Includes lip)<br>Length x Width<br>(in.) |           | Inside Dimensions<br>Length x Width<br>(mm) |           | Height<br>O.D. (mm) |     | I.D.*<br>(in.) |     | Capacity<br>(cu. ft.) (cu. m.) |       | Approx. Tote<br>Box Wt.<br>(lbs.) | Cat. No.         |
|---|-----------|---|-----------|---------------------|-----|----------------|-----|--------------------------------|-------|-----------------------------------|------------------|
| 22½ x 17½   | 572 x 445 | 20¼ x 15½                                   | 514 x 384 | 3                   | 76  | 2.5            | 64  | .44                            | 0.017 | 2.57                              | <b>MTB93030W</b> |
| 22½ x 17½   | 572 x 445 | 20¼ x 15½                                   | 514 x 384 | 5                   | 127 | 4.5            | 114 | .79                            | 0.02  | 4.0                               | <b>MTB93050W</b> |
| 22½ x 17½   | 572 x 445 | 20¼ x 15½                                   | 514 x 384 | 6                   | 152 | 5.5            | 140 | .97                            | 0.027 | 4.0                               | <b>MTB93060W</b> |
| 22½ x 17½   | 572 x 445 | 20¼ x 15½                                   | 514 x 384 | 8                   | 203 | 7.5            | 191 | 1.32                           | 0.037 | 5.25                              | <b>MTB93080W</b> |
| 22½ x 17½   | 572 x 445 | 20¼ x 15½                                   | 514 x 384 | 12                  | 305 | 11.5           | 292 | 2.03                           | 0.057 | 6.67                              | <b>MTB93120W</b> |

\*Loading height restrictions when using covers or stacking totes.  
**Note:** Other Metro totes available. See page 156.

### Dividers

| For Tote Box | Dividers                 | Maximum Tote | For Tote Box | Dividers                 | Maximum Tote |
|--------------|--------------------------|--------------|--------------|--------------------------|--------------|
| MTB93030W    | Short <b>MDS93030NAT</b> | 15           | MTB93080W    | Short <b>MDS93080NAT</b> | 15           |
|              | Long <b>MDL93030NAT</b>  | 11           |              | Long <b>MDL93080NAT</b>  | 11           |
| MTB93060W    | Short <b>MDS93060NAT</b> | 15           | MTB93120W    | Short <b>MDS93080NAT</b> | 15           |
|              | Long <b>MDL93060NAT</b>  | 11           |              | Long <b>MDL93080NAT</b>  | 11           |

### Heavy-Duty Drawers & Accessories

All Starsys Heavy-Duty drawers have an interior front-to-back dimension of 19.188" (487mm). Single Heavy-Duty drawers have an interior width of 16.375" (416mm). Double Heavy-Duty drawers have an interior width of 36.250" (920mm).

| Description  | Interior Depth<br>(in.) (mm) | Cat. No.           |
|--|------------------------------|--------------------|
| <b>Heavy-Duty Drawers — Single</b>   |                              |                    |
| 3" (76mm) SW Starsys Heavy-Duty Drawer   | 2⅞ 60                        | <b>SXRS3HD</b>     |
| 6" (152mm) SW Starsys Heavy-Duty Drawer  | 5⅞ 136                       | <b>SXRS6HD</b>     |
| 9" (229mm) SW Starsys Heavy-Duty Drawer  | 8⅞ 213                       | <b>SXRS9HD</b>     |
| 12" (305mm) SW Starsys Heavy-Duty Drawer   | 11⅞ 289                      | <b>SXRS12HD</b>    |
| Single-Wide Drawer Top No Lock (Used when shelf is required directly over a drawer or door.) |                              | <b>SXRSHDWRTOP</b> |
| <b>Heavy-Duty Drawers — Double</b>   |                              |                    |
| 3" (76mm) DW Starsys Heavy-Duty Drawer   | 2⅞ 60                        | <b>SXRD3HD</b>     |
| 6" (152mm) DW Starsys Heavy-Duty Drawer  | 5⅞ 136                       | <b>SXRD6HD</b>     |
| 9" (229mm) DW Starsys Heavy-Duty Drawer  | 8⅞ 213                       | <b>SXRD9HD</b>     |
| 12" (305mm) DW Starsys Heavy-Duty Drawer   | 11⅞ 289                      | <b>SXRD12HD</b>    |
| Double-Wide Drawer Top No Lock (Used when shelf is required directly over a drawer or door.) |                              | <b>SXRDHDWRTOP</b> |
| <b>Heavy-Duty Drawer Dividers — Single</b>   |                              |                    |
| 3" (76mm) SW Drawer Divider Kit  |                              | <b>SXRS3HDIV</b>   |
| 6" (152mm) SW Drawer Divider Kit   |                              | <b>SXRS6HDIV</b>   |
| <b>Heavy-Duty Drawer Dividers — Double</b>   |                              |                    |
| 3" (76mm) DW Drawer Divider Kit  |                              | <b>SXRD3HDIV</b>   |
| 6" (152mm) DW Drawer Divider Kit   |                              | <b>SXRD6HDIV</b>   |
| <b>Drawer Label Kits</b>   |                              |                    |
| Label Kit  |                              | <b>SXRLABKIT</b>   |



Heavy-Duty Drawer

Drawer Pulls (one required per drawer) To specify color for drawer pull, order following catalog numbers for each drawer:

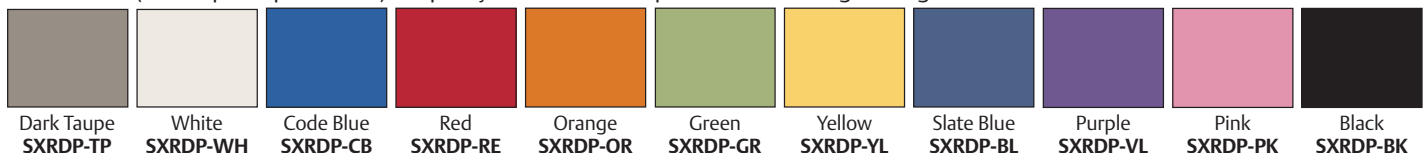

Dark Taupe **SXRDP-TP** White **SXRDP-WH** Code Blue **SXRDP-CB** Red **SXRDP-RE** Orange **SXRDP-OR** Green **SXRDP-GR** Yellow **SXRDP-YL** Slate Blue **SXRDP-BL** Purple **SXRDP-VL** Pink **SXRDP-PK** Black **SXRDP-BK**

To configure a Starsys unit to your exact specifications, please visit [www.metroconfigurator.com](http://www.metroconfigurator.com)



SXR243



SXRMON



SXRLAP

Corner Accessories

| Description                            | Dimensions — Inches (millimeters)                   | Cat. No.           |
|--|---|--------------------|
| Articulating Laptop Arm                | 18" Extension, 10" Vertical Range                   | <b>SXR LAP</b>     |
| Articulating LCD Monitor Arm           | Includes: 75 & 100mm VESA adapters                  | <b>SXR MON</b>     |
| Articulating Tablet PC Arm             | Rotates for Writing or Drawing                      | <b>SXR TAB</b>     |
| Articulating Arm Mounting Pole*        | Order with Laptop, Monitor or Tablet Arms           | <b>SXR-ARMPOLE</b> |
| Hospital Grade Power Strip & Cord Wrap | 6 Outlets, 15" Cord                                 | <b>SXR595</b>      |
| I.V. Utility Pole                      | Attaches directly to left or right rear cart corner | <b>SXRIV</b>       |
| Peel Pouch/Catheter Holder-18"         | 18H (457) x 6W (152) x 3D (76)                      | <b>SXR240</b>      |
| Peel Pouch/Catheter Holder-28"         | 27H (686) x 6W (152) x 3D (76)                      | <b>SXR243</b>      |

\*Mounting pole ordered separately.



Accessorized Pods on Starsys cart

Side Pods — All side pods are 30"H x 19.5"W x 6"L (762 x 483 x 152mm)

| Description   | Cat. No.          |
|---|-------------------|
| Fixed Side Pod (Non-Locking)                          | <b>SXRPOD</b>     |
| Fixed Side Pod (with Top-Locking Tilt Bin)*           | <b>SXRPODK1</b>   |
| Fixed Side Pod (with 3-Locking Tilt Bins)**           | <b>SXRPODK3</b>   |
| Left Swing-out Side Pod (Non-Locking)                 | <b>SXRPODSL</b>   |
| Left Swing-out Side Pod (with Top-Locking Tilt Bin)*  | <b>SXRPODSLK1</b> |
| Left Swing-out Side Pod (with 3 Locking Tilt Bins)**  | <b>SXRPODSLK3</b> |
| Right Swing-out Side Pod (Non-Locking)                | <b>SXRPODSR</b>   |
| Right Swing-out Side Pod (with Top Locking Tilt Bin)* | <b>SXRPODSRK1</b> |
| Right Swing-out Side Pod (with 3-Locking Tilt Bins)** | <b>SXRPODSRK3</b> |

\*Top Tray with Dividers and Tilt Bin included.

\*\*Top Tray with Dividers and 3 Tilt Bins included.



SXR GAS

Side Pod Accessories

| Description                             | Dimensions — Inches (millimeters)   | Cat. No.           |
|---|---|--------------------|
| Chart Holder                            | 9 <sup>9</sup> / <sub>16</sub> H (242) x 11 <sup>1</sup> / <sub>2</sub> W (292) x 4 3/4L (121)                          | <b>SXRCHRT</b>     |
| Containment Shelf Ledge                 | 1 <sup>1</sup> / <sub>2</sub> H (38) 16L (406) x 3 <sup>1</sup> / <sub>2</sub> D (89)                                   | <b>SXRPODL DGE</b> |
| Cup Holder <sup>2</sup>                 | Cup Sizes: 1 <sup>3</sup> / <sub>8</sub> (35), 2 (51), 2 <sup>1</sup> / <sub>2</sub> (64)                               | <b>SXRCUP</b>      |
| Gas Tank Holder <sup>3</sup>            | Holds C, D and E Tanks  | <b>SXRGAS-H</b>    |
| Glove Box Holder — Single               | 6 <sup>1</sup> / <sub>8</sub> H (156) x 10 <sup>1</sup> / <sub>8</sub> W (258) x 4L (102)                               | <b>FL236</b>       |
| Glove Box Holder — Triple               | 18 <sup>1</sup> / <sub>4</sub> H (464) x 10 <sup>1</sup> / <sub>8</sub> W (258) x 5 <sup>1</sup> / <sub>2</sub> L (140) | <b>FL237</b>       |
| Lockable Sharps Container & Glove Box   | 18 <sup>1</sup> / <sub>4</sub> H (464) x 13W (330) x 5 <sup>1</sup> / <sub>2</sub> L (140)                              | <b>SXR251</b>      |
| Lockable Sharps Replacement Containers  | 20/Pack, 5 Qt. (4.7L) Capacity  | <b>SXRMF252</b>    |
| Sharps Container Holder                 | 9.3H (236) x 8W (203) x 3L (76)   | <b>SXRSHRPS</b>    |
| Tilt Out Bin                            | 7 <sup>1</sup> / <sub>2</sub> H (191) 16L (406) x 3 <sup>1</sup> / <sub>2</sub> D (89)                                  | <b>SXRPODBIN</b>   |
| Top Tray (with 3 Dividers) <sup>1</sup> | 2 <sup>1</sup> / <sub>2</sub> H (57) x 16 <sup>7</sup> / <sub>8</sub> W (429) x 4 <sup>3</sup> / <sub>8</sub> L (111)   | <b>SXRPODTRY</b>   |
| Unit Shelf                              | 4 <sup>1</sup> / <sub>2</sub> D (115) x 16 <sup>7</sup> / <sub>8</sub> D (429) x 16 <sup>7</sup> / <sub>8</sub> W (429) | <b>SXRPODSLHLF</b> |
| Waste Basket & Holder                   | Holder: 15.5H (394) x 8W (203) x 3L (76)  | <b>SXRBSKT-H</b>   |
| Waste Basket Only                       | 12 <sup>1</sup> / <sub>4</sub> H (311) x 11 <sup>1</sup> / <sub>4</sub> W (286) x 8 <sup>1</sup> / <sub>4</sub> D (210) | <b>SXRBSKT</b>     |

<sup>1</sup>Attached to top of Unit Shelf (SXRFULSHLF).

<sup>2</sup>Attaches to top of Unit Shelf (SXRFULSHLF).

<sup>3</sup>One or two allowed on Fixed Non-Locking Pods Only.



SXRPODL DGE



SXRPODBIN

Starsys Carts are built to exact customer specifications, therefore, they are non-cancelable, non-returnable.

For Starsys pricing information, please contact your local Metro representative.

### Side Accessory Bracket

| Description            | Dimensions — Inches (millimeters)  | Cat. No.      |
|------------------------|--|---------------|
| Side Accessory Bracket | 4 <sup>3</sup> / <sub>8</sub> H (111) x 19 <sup>3</sup> / <sub>8</sub> W (492) | <b>SXR205</b> |



SX205 Accessory Bracket

### Side Accessory Bracket Accessories

| Description  | Dimensions — Inches (millimeters)   | Cat. No.         |
|--|---|------------------|
| Chart Holder <sup>1</sup>                            | 9 <sup>9</sup> / <sub>16</sub> H (242) x 11 <sup>1</sup> / <sub>2</sub> W (292) x 4 <sup>3</sup> / <sub>4</sub> L (121) | <b>SXRCHRT</b>   |
| Gas Tank Holder — Single <sup>2</sup>                | Holds C, D and E Tanks  | <b>SXRGAS-H</b>  |
| Glove Box Holder — Single <sup>1</sup>               | 6 <sup>1</sup> / <sub>8</sub> H (156) x 10 <sup>1</sup> / <sub>8</sub> W (258) x 4L (102)                               | <b>FL236</b>     |
| Glove Box Holder — Triple <sup>2</sup>               | 18 <sup>1</sup> / <sub>4</sub> H (464) x 10 <sup>1</sup> / <sub>8</sub> W (258) x 4L (102)                              | <b>FL237</b>     |
| Lockable Sharps Container and Glove Box <sup>1</sup> | 18 <sup>1</sup> / <sub>4</sub> H (464) x 13W (330) X 5 <sup>1</sup> / <sub>2</sub> L (140)                              | <b>SXR251</b>    |
| Lockable Sharps Replacement Containers               | 20/Pack, 5 Qt. (4.7L) Capacity  | <b>SXRMF252</b>  |
| Sharps Container Holder <sup>1</sup>                 | 9.3H (236) x 8W (203) x 3L (76)   | <b>SXRSHRPS</b>  |
| Side Bins (3 Pack) <sup>3</sup>                      | 4 (102) x 4 <sup>1</sup> / <sub>2</sub> (114) x 18 <sup>3</sup> / <sub>8</sub> (254)                                    | <b>MBP216</b>    |
| Waste Basket and Holder <sup>1</sup>                 | Holder: 15.5H (394) x 8W (203) x 3L (76)  | <b>SXRBSKT-H</b> |
| Waste Basket Only                                    | 12 <sup>1</sup> / <sub>4</sub> H (311) x 11 <sup>1</sup> / <sub>4</sub> W (286) x 8 <sup>1</sup> / <sub>4</sub> D (210) | <b>SXRBSKT</b>   |

\*Accessory Bracket(s) included.  
<sup>1</sup>Order with (1) SXR205 Accessory Bracket.  
<sup>2</sup>Order with (2) SXR205 Accessory Brackets.  
<sup>3</sup>Order with (3) SXR205 Accessory Brackets



SXR205, SXR251

### Other Accessories

| Description  | Dimensions — Inches (millimeters)   | Cat. No.           |
|--|---|--------------------|
| Extended Handle  | 4H (102) x 21 <sup>1</sup> / <sub>2</sub> W (546) x 4 <sup>1</sup> / <sub>4</sub> L (108)                               | <b>SXREHAN</b>     |
| Extended Handle (Field Retrofit)   | 4H (102) x 21 <sup>1</sup> / <sub>2</sub> W (546) x 4 <sup>1</sup> / <sub>4</sub> L (108)                               | <b>SXREHAN-KD</b>  |
| Pullout Writing Surface (Left Side)                                      | 17.5"W (445) x 15.75"L (400); (25 lb. cp.)  | <b>SXRPULLOUTL</b> |
| Pullout Writing Surface (Right Side)                                     | 17.5"W (445) x 15.75"L (400); (25 lb. cp.)  | <b>SXRPULLOUTR</b> |
| Single Wide Full-Extension Keyboard Tray                                 | 16 <sup>3</sup> / <sub>8</sub> " (417) x 13 <sup>5</sup> / <sub>8</sub> "L (346) x 2 <sup>5</sup> / <sub>8</sub> " (67) | <b>SXRSKBT</b>     |
| Double Wide Full-Extension Keyboard Tray                                 | 36 <sup>1</sup> / <sub>4</sub> " (920) x 13 <sup>5</sup> / <sub>8</sub> "L (346) x 2 <sup>5</sup> / <sub>8</sub> " (67) | <b>SXRDKBT</b>     |
| Backlit Keyboard with Clear Cover (Fits Single or Double Wide KBD Trays) |   | <b>SXRKBD</b>      |



SXRPULLOUTL



SXRSKBT



SXRDKBT



SXRKBD

### Overbridge and Accessories

| Description   | Cat. No.           |
|---|--------------------|
| (A) Overbridge Assembly with two Hanger Rails**   | <b>SXRSOB</b>      |
| Overbridge Assembly with no Hanger Rails  | <b>SXRSOB-1000</b> |
| (B) Hanger Rail (2 <sup>3</sup> / <sub>16</sub> " [55mm] H.x1" [25.4mm] W.x19 <sup>1</sup> / <sub>2</sub> " [495mm] L. usable space                                 | <b>SXROBSRAIL</b>  |
| Overbridge with Top Shelf and Hanger Rail   | <b>SXR515</b>      |
| Overbridge with 2 Shelves   | <b>SXR520</b>      |
| Overbridge Shelf***   | <b>SXR560</b>      |
| Utility Pole Including Universal Clamp (Attaches to Overbridge)   | <b>SXR566</b>      |
| Universal Clamp   | <b>SXR570</b>      |
| Short Utility Hook (package of 4) (3 <sup>1</sup> / <sub>2</sub> " [89mm] usable length)  | <b>SXR571</b>      |
| Laryngoscope Blade/Specimen Holder  | <b>SXR575</b>      |
| (C) Half-Size Metal Utility Bin (5 <sup>1</sup> / <sub>2</sub> " [140mm] H.x5 <sup>1</sup> / <sub>2</sub> " [140mm] W.x5 <sup>3</sup> / <sub>4</sub> " [146mm] L.)  | <b>SXR581</b>      |
| (D) Full-Size Metal Utility Bin (5 <sup>1</sup> / <sub>2</sub> " [140mm] H.x5 <sup>1</sup> / <sub>2</sub> " [140mm] W.x11 <sup>1</sup> / <sub>8</sub> " [292mm] L.) | <b>SXR582</b>      |
| Label/Tape Dispenser  | <b>SXR583</b>      |
| Wire Supply Basket (7" [178mm] H.x5" [127mm] W.x17" [432mm] L.)   | <b>SXR585</b>      |
| (E) Utility Bin with Cover (Package of 6)   | <b>SXR586</b>      |
| †† Sharps Container Bracket   | <b>LEC9800</b>     |
| Tilt Bin 3 Units with Brackets  | <b>SXRMF543</b>    |
| Tilt Bin 4 Units with Brackets  | <b>SXRMF544</b>    |
| Tilt Bin 6 Units with Brackets  | <b>SXRMF546</b>    |



SXREHAN

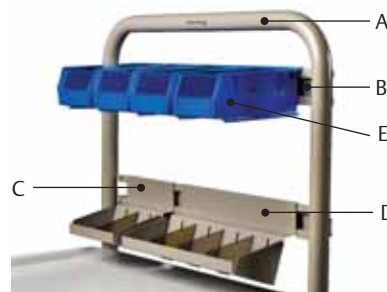

SXRSOB Overbridge Assembly (shown with optional accessories)

\*\* Maximum weight capacity for overbridge assembly is 40 lbs. (18.1kg).  
\*\*\* Maximum weight capacity for overbridge shelf is 40 lbs. (18.1kg).  
† Mounts to universal clamp in addition to hanger rail.  
†† Mounts to I.V. pole or utility pole.

To configure a Starsys unit to your exact specifications, please visit [www.metroconfigurator.com](http://www.metroconfigurator.com)

## Solutions That Move You. Mobile, Modular, Metro.



Unit shown with optional sloped top.



Tall Mobile Units are stand-alone products. Tall mobile units are available in single (22<sup>3</sup>/<sub>4</sub>" [578mm]), double (42<sup>1</sup>/<sub>2</sub>" [1080mm]) and triple (62<sup>1</sup>/<sub>2</sub>" [1588mm]) widths. The overall height of a tall mobile unit is 78" (1981mm). All units are 24<sup>7</sup>/<sub>8</sub>" (632mm) deep.

#### General Overview:

The configurable interior space is 66" (1676mm).

Triple-width units must be divided into a single & double bay or three single bays — there are no triple wide accessories.

The specification of a qwikSLOT interior or an empty interior will necessitate an extended mobile base as part of the configuration.

Starsys Mobile Units have a total recommended load rating of 900 lbs. (408kg) including the weight of the Starsys unit.

Units feature two 5" (127mm) casters — the front two casters have color-matched toe-brakes.

Tall Stationary Units are stand-alone products or may be used in conjunction with other tall units or Starsys product families. Tall stationary units are available in single and double widths only.

#### General Overview:

The overall height of a tall stationary unit is 72<sup>1</sup>/<sub>2</sub>" (1842mm). Add 11<sup>3</sup>/<sub>4</sub>" (299mm) wth sloped tops.

The configurable interior space is 66" (1676mm). The overall widths are 21<sup>1</sup>/<sub>2</sub>" (546mm) for singles and 41<sup>1</sup>/<sub>3</sub>" (1049mm) for doubles.

Filler kits are available to fill gaps between units, between the back of a unit and the wall (25" [635mm] & 30" [762mm] depths) and between tall units interfacing at 45 or 90 degrees.

All tall units must be affixed to the wall with appropriate mounting hardware utilizing the attached Starsys mounting bracket or affixed to the floor with the optional floor mounting kit.

Tall units are not intended to support cantilevered countertop sections.

Starsys Carts are built to exact customer specifications, therefore, they are non-cancelable, non-returnable.

For Starsys pricing information, please contact your local Metro representative.

For specification details, consult page 210



Cat. No. **SXRSGS1**



Cat. No. **SXRSGS2**



Cat. No. **SXRS76CM5**



Cat. No. **SXRS76CMHD2**



Cat. No. **SXRD76CM3**



Cat. No. **SXRD76CMHD1**



Cat. No. **SXRTGS2**



Cat. No. **SXRTGS3**



Cat. No. **SXRS72TU2**



Cat. No. **SXRS72TU4**



Cat. No. **SXRS72TUHD2**

To configure a Starsys unit to your exact specifications, please visit [www.metroconfigurator.com](http://www.metroconfigurator.com)

For specification details, consult page 210



Cat. No. **SXRD72TU2**



Cat. No. **SXRD72TU3**



Cat. No. **SXRD72TU6**

### Accessories

| Description   | Cat. No.          |
|---|-------------------|
| Extended Handle Assembly 4" (102mm) H.x21 <sup>1</sup> / <sub>2</sub> " [546mm] W.x 4 <sup>1</sup> / <sub>4</sub> " [108mm] L.) | <b>SXREHAN†</b>   |
| Extended Handle Assembly — KD   | <b>SXREHAN-KD</b> |
| Coat Hanger Tube  | <b>SXRSHANG</b>   |

†Unless otherwise requested, handle will be assembled on left side of unit.



Extended Handle

### Filler Kits and Trim Kits — Tall Stationary Units

| Description  | Cat. No.            |
|--|---------------------|
| Unit to Unit Filler Strip Kit                        | <b>SXR72UUFLR</b>   |
| Back Wall Trim Kit x 72" (1829mm)                    | <b>SXR72BKFLR</b>   |
| Back Wall Trim Kit x 72" (1829mm) — 30" (762mm) Deep | <b>SXR72BKFLR30</b> |
| 45° Corner Filler Strip Kit x 84" (2134mm)           | <b>SXR84CR45FLR</b> |
| 90° Corner Filler Strip Kit x 84" (2134mm)           | <b>SXR84CR90FLR</b> |



Coat Hanger Tube

### Floor Mounting Kit

| Description        | Cat. No.      |
|--------------------|---------------|
| Floor Mounting Kit | <b>SX-FLR</b> |



StarSys Carts are built to exact customer specifications, therefore, they are non-cancelable, non-returnable.  
For StarSys pricing information, please contact your local Metro representative.



## Solutions That Move You. Mobile, Modular, Metro.

Overhead cabinet shelves are removable, easy-to-clean, and are available in both solid polymer and epoxy-coated, open-wire shelf designs.

Pre-configured units are available with black epoxy countertops. Standard countertop choices include stainless steel, Trespa® and Corian®. For other options, including laminate, contact your Metro representative.

Microban® Antimicrobial Product Protection inhibits the growth of stain and odor-causing bacteria on Starsys, keeping the surface areas "cleaner between cleanings."

Drawer pull is GMP compliant and can be accented with choice of 8 available colors.

Starsys drawer options include choice of polymer drawers (3", 4½", 6", 7½", 9", 10½", and 12" heights) or heavy-duty drawers (3", 6", 9" and 12" heights), featuring stainless steel drawer interior, load-rated at 150 lbs. per drawer. Heavy-duty drawers are available in both single- and double-wide modules.



Starsys Mobile WorkCenters are built for change. They allow you to easily adapt to a changing work environment and even inspire change in your work environment.

Available Widths: Starsys Mobile WorkCenters are available in four widths; single, double, triple & single-kneewell-single.

Working Heights: Available working heights without overhead storage: 33", 36", 39", 42", 45" (with 5" casters). Deduct 2" (51mm) from unit height when specifying 3" Total-Lock casters or Leveling casters.

Total Unit Height: All units with overhead storage have a total height of 82" (2083mm) (with 5" casters). Deduct 2" from unit height when specifying 3" Total-Lock casters or Leveling casters.

Countertop Heights available with Overheads: 33", 36", 39", 42" (45" height is not available with overhead storage)



Starsys mobile workcenter units can be specified with or without overhead cabinets attached. Available overhead heights include 24", 27", 30", and 36".

Overhead cabinet accessories include light fixture, cassette bins for small item storage and organization, and poly shelf dividers.

Overhead cabinets can be specified with a variety of available doors, clear or solid style, locking or non-locking. Contact your Metro representative for more information.

Door handle detail is GMP compliant and can be accented with choice of 8 available colors.

Starsys Doors, available in multiple heights, can be specified with or without window, as well as locking and non-locking.

5" (127mm) total-lock polymer casters with easily accessible toe brakes make unit easy to maneuver in tight lab spaces. Other caster options are shown on page 217.

Available Configuration Widths: (without side pods)

Single: 23.6" (600mm)

Double: 43.4" (1103mm)

Triple: 63.2" (1606mm)

Single-Kneewell-Single: 73.0" (1855mm)

Countertops: 29" depth, available with back splash or island style (when overheads are not specified) in black epoxy, Trespa®, Corian® or stainless steel. Side splashes are available for units with back splash.

Kneewell Options: Starsys Mobile WorkCenter configurations have several kneewell options including a keyboard tray, pencil drawer (drawer pull specified separately) and support bracket. The triple unit has a right oriented kneewell option with a nominal opening of 42" (1067mm) and the single-kneewell-single configuration has a nominal opening of 30" (762mm). The kneewell area in both of these configurations is supported by a bracket assembly in the event that neither the keyboard nor pencil drawer option is specified.

To configure a Starsys unit to your exact specifications, please visit [www.metroconfigurator.com](http://www.metroconfigurator.com)

For specification details, consult page 213

Preconfigured Mobile WorkCenters with Epoxy Tops — 46.01

All preconfigured units below come standard with taupe door/drawer pulls and polymer 5" (127mm) diameter casters (2-total lock, 2-swivel). Overhead units include 27" (686mm) cabinets with locking clear doors and two poly shelves. The countertops are 1" (25mm) thick black epoxy resin. Other top materials and accessories are available upon request.

| Description   | Cat. No.             | Overall Dimensions Width/Length/Height | Cat. No. With Overhead | Overall Dimensions Width/Length/Height |
|---|----------------------|--|------------------------|--|
| <b>Single-Wide Units</b>                            |                      |  |                        |  |
| Single-Wide Heavy-Duty 12" (305mm) (2)              | <b>SXRMWS33EBS1</b>  | 28.6x23.6x33.5                         |                        |  |
| Single-Wide with Standard Drawers                   | <b>SXRMWS36EBS2</b>  | 28.6x23.6x36.5                         | <b>SXRMWS36EOH2</b>    | 28.6x23.6x81.5                         |
| Single-Wide with Locking Doors and Poly Shelves     | <b>SXRMWS36EBS3</b>  | 28.6x23.6x36.5                         | <b>SXRMWS36EOH3</b>    | 28.6x23.6x81.5                         |
| <b>Double-Wide Units</b>                            |                      |  |                        |  |
| Double-Wide Heavy-Duty 12" (305mm) (2)              | <b>SXRMWD33EBS1</b>  | 28.6x43.4x33.5                         |                        |  |
| Double-Wide with Standard Drawers                   | <b>SXRMWD36EBS2</b>  | 28.6x43.4x36.5                         | <b>SXRMWD36EOH2</b>    | 28.6x43.4x81.5                         |
| Double-Wide with Locking Doors and Poly Shelves     | <b>SXRMWD36EBS3</b>  | 28.6x43.4x36.5                         | <b>SXRMWD36EOH3</b>    | 28.6x43.4x81.5                         |
| <b>Triple-Wide Units</b>                            |                      |  |                        |  |
| Triple-Wide with S & D HD Drawers                   | <b>SXRMWT36EBS6</b>  | 28.6x63.2x36.5                         | <b>SXRMWT36EOH6</b>    | 28.6x63.2x81.5                         |
| Triple-Wide with Locking Doors and Wire Shelves     | <b>SXRMWT36EBS4</b>  | 28.6x63.2x36.5                         |                        |  |
| Triple-Wide with Locking Doors and Poly Shelves     |                      |  | <b>SXRMWT36EOH3</b>    | 28.6x63.2x36.5                         |
| Triple Kneewell with Standard Drawers               | <b>SXRMWTK36EBS2</b> | 28.6x63.2x36.5                         | <b>SXRMWTK36EOH2</b>   | 28.6x63.2x81.5                         |
| Triple Kneewell with Locking Doors and Poly Shelves | <b>SXRMWTK36EBS3</b> | 28.6x63.2x36.5                         | <b>SXRMWTK36EOH3</b>   | 28.6x63.2x81.5                         |
| Triple Kneewell with Standard Drawers               | <b>SXRMWTK39EBS2</b> | 28.6x63.2x39.5                         |                        |  |
| Triple Kneewell with Locking Doors and Poly Shelves | <b>SXRMWTK39EBS3</b> | 28.6x63.2x39.5                         |                        |  |
| Single Kneewell with HD Drawers                     | <b>SXRMWSK33EBS1</b> | 28.6x73x33.5                           |                        |  |
| Single Kneewell with Standard Drawers               | <b>SXRMWSK39EBS2</b> | 28.6x73x39.5                           |                        |  |
| Single Kneewell with Locking Doors and Poly Shelves | <b>SXRMWSK39EBS3</b> | 28.6x73x39.5                           |                        |  |



Cat. No. **SXRMWS33EBS1**



Cat. No. **SXRMWS36EBS2**



Cat. No. **SXRMWS36EBS3**



Cat. No. **SXRMWD33EBS1**



Cat. No. **SXRMWD36EBS2**



Cat. No. **SXRMWD36EBS3**



Cat. No. **SXRMWT36EBS4**



Cat. No. **SXRMWT36EBS6**

\*Trespa Phenolic, Laminate and Stainless Steel tops are available. Contact your Metro representative.  
 Starsys Carts are built to exact customer specifications, therefore, they are non-cancelable, non-returnable.  
 For Starsys pricing information, please contact your local Metro representative.

Mobile WorkCenters with Epoxy Tops and Overheads\*



Cat. No. **SXRMWTK36EBS2**



Cat. No. **SXRMWTK36EBS3**



Cat. No. **SXRMWTK39EBS2**



Cat. No. **SXRMWTK39EBS3**



Cat. No. **SXRMWSK33EBS1**



Cat. No. **SXRMWSK39EBS2**



Cat. No. **SXRMWSK39EBS3**



Cat. No. **SXRMWS36EOH2**



Cat. No. **SXRMWS36EOH3**



Cat. No. **SXRMWD36EOH2**

\*Trespa Phenolic, Laminate and Stainless Steel tops are available. Contact your Metro representative.

To configure a Starsys unit to your exact specifications, please visit [www.metroconfigurator.com](http://www.metroconfigurator.com)

For specification details, consult page 213

Mobile WorkCenters with Epoxy Tops and Overheads\*



Cat. No. **SXRMWD36EOH3**



Cat. No. **SXRMWT36EOH6**



Cat. No. **SXRMWT36EOH3**



Cat. No. **SXRMWTK36EOH2**



Cat. No. **SXRMWTK36EOH3**



\*Trespa Phenolic, Laminate and Stainless Steel tops are available. Contact your Metro representative. Starsys Carts are built to exact customer specifications, therefore, they are non-cancelable, non-returnable. For Starsys pricing information, please contact your local Metro representative.

### Starsys Drawers

Starsys offers two types of drawers to address varying user requirements. Below is a feature comparison to help determine the appropriate drawers system for a desired application.

| Feature                                      | Polymer Drawers | Heavy-Duty Drawers |
|--|-----------------|--------------------|
| Light to medium weight capacity (25-40 lbs.) | X               |                    |
| Heavy weight capacity (up to 150 lbs.)       |                 | X                  |
| Removable tote                               | X               |                    |
| Inner panel compatible                       | X               |                    |
| Slotted post insert compatible               |                 | X                  |
| Ball bearing slide                           |                 | X                  |
| Full extension                               | X               | X                  |
| Stainless steel interior                     |                 | X                  |
| Polymer interior                             | X               |                    |
| Easy to clean                                | X               |                    |
| Easily removed/reconfigured                  | X               |                    |
| Adjustable dividers                          | X               | X                  |
| Lockable                                     | X               | X                  |
| Optional lock cover                          | X               |                    |
| Label kits                                   | X               | X                  |
| Accommodate hanging files                    |                 | X                  |



Removable drawer totes allow for exchange or convenient access outside of cart (Page 205)

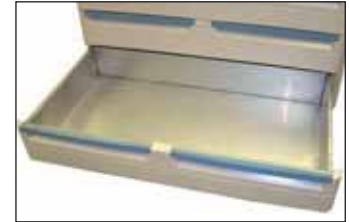

Heavy-Duty Drawer (Page 207)

### Starsys™ Doors

Starsys offers two types of doors, hinged and tambour. The hinged doors are available in a choice of solid or clear. Each offers unique benefits to address varying user requirements. Below is a feature comparison to help determine the appropriate door selection for a desired application.

| Feature             | Hinged Solid Door | Hinged Clear Door | Benefit   |
|---------------------|-------------------|-------------------|---|
| Visual Security     | X                 |                   | Puts inventory out of plain site                                  |
| Hides clutter       | X                 |                   | Enhances department aesthetics                                    |
| Visual inventory    |                   | X                 | Protection is not compromised when looking for supplies           |
| Lockable            | X                 | X                 | Added security  |
| Space saving        |                   |                   | Does not encroach on work space                                   |
| Door swing overlaps | X                 | X                 | Promotes door closure to protect supplies adjacent storage spaces |
| 90 degree hinge     | X                 | X                 | Prevents door from overlapping adjacent space                     |
| 270 degree hinge    | X                 | X                 | Allows door to swing to side of cabinet or cart                   |
| Polymer             | X                 | X                 | Impact and corrosion protection                                   |
| Left or right hinge | X                 | X                 | Provides appropriate swing direction                              |
| Center closing      | X                 | X                 | Allows for double wide storage compartments                       |
| Door label holders  | X                 | X                 | Provides clean replenishable labeling option                      |
| Non-locking         | X                 | X                 | Lower cost alternative  |



Solid Doors



Clear Door

### Starsys Cart Accessory Casters

Standard Starsys Mobile Unit Casters. All mobile units come standard with these casters.

| Description                                     | Cat. No.      |
|---|---------------|
| (2) Front Polymer 5" (127mm) Total-Lock Casters | <b>B5P-TL</b> |
| (2) Rear Polymer 5" (127mm) Swivel Casters      | <b>B5P-SW</b> |

### Caster Options

|  |  |   |   |
|--|--|---|---|
| <p>3" (76mm) Total-Lock Caster:<br/>Utilize 3" total-lock plate casters for limited mobile applications or when additional storage area is required.</p>  <p>B3P-TL</p> | <p>5" (127mm) Stainless Steel Caster:<br/>Recommended for corrosive environments.</p>  <p>B5PBGSA</p> | <p>5" (127mm) Total-Lock, All-Polymer Caster:<br/>Recommended for corrosive environments. All-polymer total-lock plate caster is an economical alternative to stainless casters.</p>  <p>B5PC-TL</p> | <p>Stabilizer/Leveling Caster:<br/>Recommended for applications where benchtop equipment demands unit stability and/or a level worksurface. Engage caster foot for stability, release for mobility.</p>  <p>B3N-AS</p> |
| <p>5" (127mm) Swivel/Lock (Directional) Casters (available by request)<br/>Other specialty caster options are available, consult your Metro representative.</p>  |  |   |   |

To configure a Starsys unit to your exact specifications, please visit [www.metroconfigurator.com](http://www.metroconfigurator.com)

## Mobile WorkCenter Countertop Options Epoxy Tops — Mobile WorkCenters



Mobile WorkCenter with Epoxy Top

| Description  | Cat. No.           |
|--|--------------------|
| <b>Tops with Backsplash</b>                              |                    |
| Epoxy Top 21" (533mm) L. Backsplash — Black              | <b>SXRCT2B23EB</b> |
| Epoxy Top 42" (1067mm) L. Backsplash — Black             | <b>SXRCT2B43EB</b> |
| Epoxy Top 63" (1600mm) L. Backsplash — Black             | <b>SXRCT2B63EB</b> |
| Epoxy Top 73" (1854mm) L. Backsplash — Black             | <b>SXRCT2B73EB</b> |
| <b>Island Tops — No Backsplash</b>                       |                    |
| Epoxy Top 21" (533mm) L. No Backsplash — Black           | <b>SXRCT2N23EB</b> |
| Epoxy Top 42" (1067mm) L. No Backsplash — Black          | <b>SXRCT2N43EB</b> |
| Epoxy Top 63" (1600mm) L. No Backsplash — Black          | <b>SXRCT2N63EB</b> |
| Epoxy Top 73" (1854mm) L. No Backsplash — Black          | <b>SXRCT2N73EB</b> |
| <b>Tops with Backsplash and Overheads</b>                |                    |
| Epoxy Top 21" (533mm) L. Backsplash Overhead — Black     | <b>SXRCT2U23EB</b> |
| Epoxy Top 42" (1067mm) L. Backsplash Overhead — Black    | <b>SXRCT2U43EB</b> |
| Epoxy Top 63" (1600mm) L. Backsplash Overhead — Black    | <b>SXRCT2U63EB</b> |
| Epoxy Top 73" (1854mm) L. Backsplash Overhead — Black    | <b>SXRCT2U73EB</b> |
| <b>Epoxy Top Brackets — Not Required for Island Tops</b> |                    |
| Single Epoxy Countertop Back Bracket                     | <b>SXRSEB</b>      |
| Double Epoxy Countertop Back Bracket                     | <b>SXRDEB</b>      |
| Triple Epoxy Countertop Back Bracket                     | <b>SXRTEB</b>      |
| <b>Side Splash Options</b>                               |                    |
| Epoxy Side Splash — Black                                | <b>SXRCN2EB</b>    |
| Epoxy Side Splash Overhead — Black                       | <b>SXRCN2EB</b>    |



Mobile WorkCenter with Stainless Steel Top

## Stainless Steel Tops — Mobile WorkCenters

| Description  | Cat. No.          |
|--|-------------------|
| <b>Tops with Backsplash</b>                                      |                   |
| Stainless Steel Mobile WorkCenter Countertop — Single Backsplash | <b>SXRCT2B23S</b> |
| Stainless Steel Mobile WorkCenter Countertop — Double Backsplash | <b>SXRCT2B43S</b> |
| Stainless Steel Mobile WorkCenter Countertop — Triple Backsplash | <b>SXRCT2B63S</b> |
| Stainless Steel Mobile WorkCenter Countertop — S-KW-S Backsplash | <b>SXRCT2B73S</b> |
| <b>Island Tops — No Backsplash</b>                               |                   |
| Stainless Steel Mobile WorkCenter Countertop — Single Island     | <b>SXRCT2N23S</b> |
| Stainless Steel Mobile WorkCenter Countertop — Double Island     | <b>SXRCT2N43S</b> |
| Stainless Steel Mobile WorkCenter Countertop — Triple Island     | <b>SXRCT2N63S</b> |
| Stainless Steel Mobile WorkCenter Countertop — S-KW-S Island     | <b>SXRCT2N73S</b> |
| <b>Tops with Backsplash and Overheads</b>                        |                   |
| Stainless Steel Mobile WorkCenter Countertop — Single Overhead   | <b>SXRCT2U23S</b> |
| Stainless Steel Mobile WorkCenter Countertop — Double Overhead   | <b>SXRCT2U43S</b> |
| Stainless Steel Mobile WorkCenter Countertop — Triple Overhead   | <b>SXRCT2U63S</b> |
| Stainless Steel Mobile WorkCenter Countertop — S-KW-S Overhead   | <b>SXRCT2U73S</b> |

See pages 226-227 for Overhead Cabinet Selection

\*Base unit working height is equal to Base interior height +9" [229mm]  
(based on 5" [127mm] casters)  
Overhead exterior height is equal to Overhead interior height +2.5" [64mm]

Starsys Carts are built to exact customer specifications, therefore, they are non-cancelable, non-returnable.  
For Starsys pricing information, please contact your local Metro representative.

## Mobile WorkCenter Countertop Options (continued) Trespa® Phenolic Tops — Mobile WorkCenters

| Description   | Cat. No.   |
|---|------------|
| <b>Tops with Backsplash — No Overheads</b>                            |            |
| Trespa Phenolic Mobile WorkCenter Countertop — Single Backsplash      | SXRCT2B23T |
| Trespa Phenolic Mobile WorkCenter Countertop — Double Backsplash      | SXRCT2B43T |
| Trespa Phenolic Mobile WorkCenter Countertop — Triple Backsplash      | SXRCT2B63T |
| Trespa Phenolic Mobile WorkCenter Countertop — S-KW-S Backsplash      | SXRCT2B73T |
| <b>Island Tops — No Backsplash</b>                                    |            |
| Trespa Phenolic Mobile WorkCenter Countertop — Single Island          | SXRCT2N23T |
| Trespa Phenolic Mobile WorkCenter Countertop — Double Island          | SXRCT2N43T |
| Trespa Phenolic Mobile WorkCenter Countertop — Triple Island          | SXRCT2N63T |
| Trespa Phenolic Mobile WorkCenter Countertop — S-KW-S Island          | SXRCT2N73T |
| <b>Tops with Backsplash and Overheads</b>                             |            |
| Trespa Phenolic Mobile WorkCenter Countertop — Single Overhead        | SXRCT2O23T |
| Trespa Phenolic Mobile WorkCenter Countertop — Double Overhead        | SXRCT2O43T |
| Trespa Phenolic Mobile WorkCenter Countertop — Triple Overhead        | SXRCT2O63T |
| Trespa Phenolic Mobile WorkCenter Countertop — S-KW-S Overhead        | SXRCT2O73T |
| <b>Side Splash Options</b>  |            |
| Trespa Phenolic Mobile WorkCenter Countertop — Side Splash Backsplash | SXRCN2T    |
| Trespa Phenolic Mobile WorkCenter Countertop — Side Splash Overhead   | SXRCCS2T   |



Mobile WorkCenter with Trespa® Phenolic Top

## Corian® Tops — Mobile WorkCenters

| Description                                | Size          | Cat. No. Tarragon | Cat. No. Flint | Cat. No. Matterhorn | Cat. No. Stone Harbor | Cat. No. Silt |
|--|---------------|-------------------|----------------|---------------------|-----------------------|---------------|
| <b>Tops with Backsplash — No Overheads</b> |               |                   |                |                     |                       |               |
| Single                                     | 28.568x23.575 | SXRCT3B23CTA      | SXRCT3B23CFL   | SXRCT3B23CMA        | SXRCT3B23CSH          | SXRCT3B23CSL  |
| Double                                     | 28.568x43.375 | SXRCT3B43CTA      | SXRCT3B43CFL   | SXRCT3B43CMA        | SXRCT3B43CSH          | SXRCT3B43CSL  |
| Triple                                     | 28.568x63.175 | SXRCT3B63CTA      | SXRCT3B63CFL   | SXRCT3B63CMA        | SXRCT3B63CSH          | SXRCT3B63CSL  |
| Single-Kneewell-Single                     | 28.568x73.075 | SXRCT3B73CTA      | SXRCT3B73CFL   | SXRCT3B73CMA        | SXRCT3B73CSH          | SXRCT3B73CSL  |
| <b>Island Tops — No Backsplash</b>         |               |                   |                |                     |                       |               |
| Single                                     | 28.568x23.575 | SXRCT3N23CTA      | SXRCT3N23CFL   | SXRCT3N23CMA        | SXRCT3N23CSH          | SXRCT3N23CSL  |
| Double                                     | 28.568x43.375 | SXRCT3N43CTA      | SXRCT3N43CFL   | SXRCT3N43CMA        | SXRCT3N43CSH          | SXRCT3N43CSL  |
| Triple                                     | 28.568x63.175 | SXRCT3N63CTA      | SXRCT3N63CFL   | SXRCT3N63CMA        | SXRCT3N63CSH          | SXRCT3N63CSL  |
| Single-Kneewell-Single                     | 28.568x73.075 | SXRCT3N73CTA      | SXRCT3N73CFL   | SXRCT3N73CMA        | SXRCT3N73CSH          | SXRCT3N73CSL  |
| <b>Tops with Backsplash and Overheads</b>  |               |                   |                |                     |                       |               |
| Single                                     | 28.568x23.575 | SXRCT3U23CTA      | SXRCT3U23CFL   | SXRCT3U23CMA        | SXRCT3U23CSH          | SXRCT3U23CSL  |
| Double                                     | 28.568x43.375 | SXRCT3U43CTA      | SXRCT3U43CFL   | SXRCT3U43CMA        | SXRCT3U43CSH          | SXRCT3U43CSL  |
| Triple                                     | 28.568x63.175 | SXRCT3U63CTA      | SXRCT3U63CFL   | SXRCT3U63CMA        | SXRCT3U63CSH          | SXRCT3U63CSL  |
| Single-Kneewell-Single                     | 28.568x73.075 | SXRCT3U73CTA      | SXRCT3U73CFL   | SXRCT3U73CMA        | SXRCT3U73CSH          | SXRCT3U73CSL  |
| <b>Side Splash Options</b>                 |               |                   |                |                     |                       |               |
| With Overhead Storage                      | 3x25.063      | SXRS3CTA          | SXRS3CFL       | SXRS3CMA            | SXRS3CSH              | SXRS3CSL      |
| Without Overhead Storage                   | 3x20.688      | SXRN3CTA          | SXRN3CFL       | SXRN3CMA            | SXRN3CSH              | SXRN3CSL      |

\*Base unit working height is equal to Base interior height +9" [229mm] (based on 5" [127mm] casters) Overhead exterior height is equal to Overhead interior height +2.5" [64mm]

## Kneewell Options

| Description   | Cat. No.       |
|---|----------------|
| <b>30" (762mm) Kneewell</b>                                 |                |
| 30" (762mm) Brkt Assembly Keyboard Tray                     | SXR30BRKTKB-MW |
| 30" (762mm) Brkt Assembly Blank                             | SXR30BRKT-MW   |
| 30" (762mm) Brkt Assembly Pencil Drawer                     | SXR30BRKTPN-MW |
| <b>42" (1067mm) Kneewell</b>                                |                |
| 42" (1067mm) Brkt Assembly Keyboard Tray, Mobile WorkCenter | SXR42BRKTKB-MW |
| 42" (1067mm) Brkt Assembly Blank, Mobile WorkCenter         | SXR42BRKT-MW   |
| 42" (1067mm) Brkt Assembly Pencil Drawer, Mobile WorkCenter | SXR42BRKTPN-MW |

### Solid Surface Colors



To configure a Starsys unit to your exact specifications, please visit [www.metroconfigurator.com](http://www.metroconfigurator.com)



### Mobile WorkCenter Overhead Cabinet Support

Select overhead cabinets on pages 226 and 227.

| Description   | Cat. No.  |
|---|-----------|
| <b>Lateral Supports for Overhead Cabinets — Select one per WorkCenter</b> |           |
| Overhead Structure Single Wide Mobile WorkCenter                          | SXRSMWOHB |
| Overhead Structure Double Wide Mobile WorkCenter                          | SXRDMWOHB |
| Overhead Structure Triple Wide Mobile WorkCenter                          | SXRTMWOHB |
| Overhead Structure Single-Kneewell Mobile WorkCenter                      | SXRKMWOHB |

| <b>Vertical Supports for Overhead Cabinets — Select one pair per WorkCenter</b> |              |
|---|--------------|
| 24" (610mm) Base Interior with 24" (610mm) Overhead Interior (1 Pair)           | SXRMWUP24-24 |
| 24" (610mm) Base Interior with 27" (686mm) Overhead Interior (1 Pair)           | SXRMWUP24-27 |
| 24" (610mm) Base Interior with 30" (762mm) Overhead Interior (1 Pair)           | SXRMWUP24-30 |
| 24" (610mm) Base Interior with 33" (838mm) Overhead Interior (1 Pair)           | SXRMWUP24-33 |
| 27" (686mm) Base Interior with 24" (610mm) Overhead Interior (1 Pair)           | SXRMWUP27-24 |
| 27" (686mm) Base Interior with 27" (686mm) Overhead Interior (1 Pair)           | SXRMWUP27-27 |
| 27" (686mm) Base Interior with 30" (762mm) Overhead Interior (1 Pair)           | SXRMWUP27-30 |
| 30" (762mm) Base Interior with 24" (610mm) Overhead Interior (1 Pair)           | SXRMWUP30-24 |
| 30" (762mm) Base Interior with 27" (686mm) Overhead Interior (1 Pair)           | SXRMWUP30-27 |
| 33" (838mm) Base Interior with 24" (610mm) Overhead Interior (1 Pair)           | SXRMWUP33-24 |

| <b>Overhead Cabinet and Shelving Combination — Vertical Supports</b> |               |
|--|---------------|
| 24" (610mm) Base 24" (610mm) Overhead Interior and Slotted Inserts   | SXRMWUP24Q-24 |
| 24" (610mm) Base 27" (686mm) Overhead Interior and Slotted Inserts   | SXRMWUP24Q-27 |
| 24" (610mm) Base 30" (762mm) Overhead Interior and Slotted Inserts   | SXRMWUP24Q-30 |
| 24" (610mm) Base 33" (838mm) Overhead Interior and Slotted Inserts   | SXRMWUP24Q-33 |
| 27" (686mm) Base 24" (610mm) Overhead Interior and Slotted Inserts   | SXRMWUP27Q-24 |
| 27" (686mm) Base 27" (686mm) Overhead Interior and Slotted Inserts   | SXRMWUP27Q-27 |
| 27" (686mm) Base 30" (762mm) Overhead Interior and Slotted Inserts   | SXRMWUP27Q-30 |
| 30" (762mm) Base 24" (610mm) Overhead Interior and Slotted Inserts   | SXRMWUP30Q-24 |
| 30" (762mm) Base 27" (686mm) Overhead Interior and Slotted Inserts   | SXRMWUP30Q-27 |
| 33" (838mm) Base 24" (610mm) Overhead Interior and Slotted Inserts   | SXRMWUP33Q-24 |



### Mobile WorkCenter Reagent Shelving and Supports

| Description                               | Cat. No.  |
|---|-----------|
| <b>Reagent Shelving Options</b>           |           |
| Shelf Assembly — Single width             | SXRSMWSHF |
| Shelf Assembly — Double width             | SXRDMWSHF |
| Shelf Assembly — Triple width             | SXRTMWSHF |
| Shelf Assembly — Single-Kneewell — Single | SXRKMWSHF |

| <b>Lateral Support for Reagent Shelving — Select one per WorkCenter</b> |          |
|---|----------|
| Cross Member — Single width   | SXRSMWSB |
| Cross Member — Double width   | SXRDMWSB |
| Cross Member — Triple width   | SXRTMWSB |
| Cross Member — Single-Kneewell — Single                                 | SXRKMWSB |

| <b>Vertical Supports with Slotted Inserts for Reagent Shelving — Select one pair per WorkCenter</b> |            |
|---|------------|
| 24" (610mm) Base Interior with Slotted Inserts (1 Pair)   | SXRMWUP24Q |
| 27" (686mm) Base Interior with Slotted Inserts (1 Pair)   | SXRMWUP27Q |
| 30" (762mm) Base Interior with Slotted Inserts (1 Pair)   | SXRMWUP30Q |
| 33" (838mm) Base Interior with Slotted Inserts (1 Pair)   | SXRMWUP33Q |

\*Base unit working height is equal to Base interior height +9" [229mm] (based on 5" [127mm] casters) Overhead exterior height is equal to Overhead interior height +2.5" [64mm]

Starsys Carts are built to exact customer specifications, therefore, they are non-cancelable, non-returnable.

For Starsys pricing information, please contact your local Metro representative.

## Solutions That Move You. Mobile, Modular, Metro.



### Starsys Stationary WorkCenters

Starsys WorkCenters are designed to be a fully integrated, fully adaptable, modular system. WorkCenters can be stand alone products or can be a configured section within a larger product configuration. WorkCenters combine valuable lower storage areas with finished modular countertops to offer a complete storage and work area solution. Starsys WorkCenters are made up of two key components: base units and countertops. Understanding how these two elements work together is the key to understanding the Starsys WorkCenters line. While sections of Starsys WorkCenters can be configured into many physical combinations, these sections are typically divided into two categories: “straight run” or “corner” configurations.

**Working Heights:** Starsys WorkCenters are available in the following working heights: 30" (762mm), 33" (838mm), 36" (914mm), 39" (990mm) and 42" (1067mm). Within each working height there is up to 2.5" (64mm) of additional height adjustment via the four adjustable leveling feet in each base unit.

### Starsys Base Units

Base units are the products that provide valuable lower storage areas, as well as providing the necessary support for countertops. Base units are the most critical part of a configuration with countertops. Their total combined length and placement will determine the length of the associated countertops in the design. Their placement will determine the placement and size of necessary kneewells and provide support for valuable corner work areas. All Starsys base units are available in light taupe but have the flexibility to be accented with various door & drawer handle colors. Countertop color selection and cove base color selections may be used to accent the base unit color.

- Microban® antimicrobial product protection inhibits the growth of mold, mildew, and bacteria keeping the surface area “cleaner between cleanings.”

**System Widths:** Base Units are available in Single and Double widths.

**System Heights:** Base Units are designed to work with the following nominal countertop heights: 30" (762mm), 33" (838mm), 36" (914mm), 39" (990mm) & 42" (1067mm)

To configure a Starsys unit to your exact specifications, please visit [www.metroconfigurator.com](http://www.metroconfigurator.com)

For specification details, consult page 221

Preconfigured WorkCenter Base Units



Cat. No. **SXRS30BU1**



Cat. No. **SXRS30BU2**



Cat. No. **SXRS30BU3**



Cat. No. **SXRS30BU4**



Cat. No. **SXRS30BUHD1**



Cat. No. **SXRD30BU1**



Cat. No. **SXRD30BU2**



Cat. No. **SXRD30BUHD1**



Cat. No. **SXRD30BUHD2**



Cat. No. **SXRS36BU1**



Cat. No. **SXRS36BU2**



Cat. No. **SXRS36BU3**



Cat. No. **SXRS36BU4**



Cat. No. **SXRS36BU6**



Cat. No. **SXRS36BUHD1**



Cat. No. **SXRS36BUHD2**



Cat. No. **SXRD36BU1**



Cat. No. **SXRD36BU2**

Starsys Carts are built to exact customer specifications, therefore, they are non-cancelable, non-returnable.  
For Starsys pricing information, please contact your local Metro representative.

Preconfigured WorkCenter Base Units



Cat. No. SXR36BU3



Cat. No. SXR36BU4



Cat. No. SXR36BU6



Cat. No. SXR36BUHD2



Cat. No. SXR39BU1



Cat. No. SXR39BU3



Cat. No. SXR39BU4



Cat. No. SXR39BU6



Cat. No. SXR39BUHD1



Cat. No. SXR39BUHD2

To configure a Starsys unit to your exact specifications, please visit [www.metroconfigurator.com](http://www.metroconfigurator.com)

For specification details, consult page 221



Valance Kit



30° Kneewell Bracket with Pencil Drawer Option

**Countertop Support Brackets:**

The counter-to-counter bracket allows a countertop adjacent to a WorkCenter section with base unit to be supported at the same working height without the need for an additional base unit. The offset counter bracket allows for similar configurations but accommodates change in the working heights by dropping the adjacent countertop by 3", 6", or 9" (76, 152, or 229mm) as required by the application.

**Base Unit Trim Kits**

| Description  | Cat. No.     |
|--|--------------|
| <b>Back Wall Trim Kits — 25" Deep Countertops</b>            |              |
| Back Wall Trim Kit x 39 (all heights)                        | SXR39BKFLR   |
| <b>Back-to-Back Cabinet Trim Kits — 25" Deep Countertops</b> |              |
| Back to Back Filler for 30" H — 25" Countertop               | SXR30BBFLR   |
| Back to Back Filler for 33" H — 25" Countertop               | SXR33BBFLR   |
| Back to Back Filler for 36" H — 25" Countertop               | SXR36BBFLR   |
| Back to Back Filler for 39" H — 25" Countertop               | SXR39BBFLR   |
| Back to Back Filler for 42" H — 25" Countertop               | SXR42BBFLR   |
| <b>Back Wall Trim Kits — 30" Deep Countertops</b>            |              |
| Back Wall Trim for 30" H — 30" Countertop                    | SXR30BKFLR30 |
| Back Wall Trim for 33" H — 30" Countertop                    | SXR33BKFLR30 |
| Back Wall Trim for 36" H — 30" Countertop                    | SXR36BKFLR30 |
| Back Wall Trim for 39" H — 30" Countertop                    | SXR39BKFLR30 |
| Back Wall Trim for 42" H — 30" Countertop                    | SXR42BKFLR30 |
| <b>Back-to-Back Cabinet Trim Kits — 30" Deep Countertops</b> |              |
| Back to Back Filler for 30" H — 30" Countertop               | SXR30BBFLR30 |
| Back to Back Filler for 33" H — 30" Countertop               | SXR33BBFLR30 |
| Back to Back Filler for 36" H — 30" Countertop               | SXR36BBFLR30 |
| Back to Back Filler for 39" H — 30" Countertop               | SXR39BBFLR30 |
| Back to Back Filler for 42" H — 30" Countertop               | SXR42BBFLR30 |
| <b>Unit-to-Unit Filler Kits</b>                              |              |
| Unit to Unit Filler Strip Kit (10 pieces/kit)                | SXR72UUFLR   |
| <b>Corner Filler Kits</b>                                    |              |
| 45 Degree Corner Filler Strip Kit x 84                       | SXR84CR45FLR |
| 90 Degree Corner Filler Strip Kit x 84                       | SXR84CR90FLR |

**WorkCenter Base Unit Accessories**

| Description                             | Cat. No.    |
|---|-------------|
| <b>Kneewell Options and Accessories</b> |             |
| Undercounter Keyboard Tray              | SXRKYBDTRY  |
| 30 Brkt Assembly Blank                  | SXR30BRKT   |
| 30 Brkt Assembly Keyboard Tray          | SXR30BRKTKB |
| 30 Brkt Assembly Pencil Drawer          | SXR30BRKTPN |
| 42 Brkt Assembly Blank                  | SXR42BRKT   |
| 42 Brkt Assembly Keyboard Tray          | SXR42BRKTKB |
| 42 Brkt Assembly Pencil Drawer          | SXR42BRKTPN |
| <b>Sink Valance</b>                     |             |
| Sink Valance Kit                        | SXRSINKVLC  |
| <b>Floor Mounting Kit</b>               |             |
| Floor Mounting Kit                      | SXR-FLR     |

**Countertop Accessories**

| Description                         | Cat. No.    |
|-------------------------------------|-------------|
| <b>Countertop Mounting Brackets</b> |             |
| Counter to Counter Bracket          | SXRCCBRKT   |
| Counter to Wall Bracket             | SXRCWBRKT   |
| Offset Counter Bracket — 3          | SXROST3BRKT |
| Offset Counter Bracket — 6          | SXROST6BRKT |
| Offset Counter Bracket — 9          | SXROST9BRKT |
| <b>Countertop Hole Grommet Kits</b> |             |
| Hole Grommet Kit                    | SXRHOLEGRMT |

Starsys Carts are built to exact customer specifications, therefore, they are non-cancelable, non-returnable.

For Starsys pricing information, please contact your local Metro representative.

Starsys™ WorkCenters — Sinks, Fixtures and Eye Washes — 8.01

Below is a sampling of the wide variety of single- and double-bay sinks, faucets, eye washes and other fixtures available with countertop units: black epoxy sinks, stainless steel sinks (lipped or undermount), standard and laboratory grade faucets (deck or floor mount). Pure water and pre-rinse faucets also available. Consult your Metro representative.



**Stainless Steel Sink and Faucet Kit**  
Includes 12" x 12" x 7 1/2" (305 x 305 x 191mm) stainless steel sink bowl, chrome-plated faucet (6" [152mm] swivel gooseneck wrist blade handles), trap and drain.  
**Cat. No. SC0459**



**Laboratory Mixing Faucet**  
Deck mounted, 6" (152mm) swing vacuum breaker, 10 serration hose end gooseneck, four arm handles.  
**Cat No. SC0734A**



**Stainless Steel Sink and Faucet Kit**  
Includes 14" x 18" x 7 1/2" (356 x 457 x 191mm) stainless steel sink bowl, chrome-plated faucet (6" [152mm] swivel gooseneck wrist blade handles) trap and drain.  
**Cat. No. SC0460**



**Laboratory Mixing Faucet**  
Deck mounted, 6" (152mm) swing vacuum breaker gooseneck, 10 serration hose end and four arm handles.  
**Cat No. SCP1830Q**



**Black Epoxy-Lipped Sink Bowl**  
Includes 16" x 12" x 8" (406 x 305 x 203mm) bowl, center outlet and strainer.  
**Cat. No. SCP1148F**



**Eye Wash (Rear Mount)**  
Polished chrome plated brass, right-hand deck mount AutoFlow™, GS-Plus™ spray heads 90° swing-down flip-top spray head dust covers.  
**Cat. No. SCP0734C**



**Black Epoxy Lipped Sink Bowl**  
Includes 25" x 15" x 10" (635 x 381 x 254mm) bowl, corner outlet and strainer.  
**Cat. No. SCP1320B**



**Eye Wash (Right-Side Mount)**  
12.5" (318mm) swing away arm with swivel valve, right side deck mount, acetal dual stream heads with integral hinged covers.  
**Cat No. SCP11771**

To configure a Starsys unit to your exact specifications, please visit [www.metroconfigurator.com](http://www.metroconfigurator.com)

## Solutions That Move You. Mobile, Modular, Metro.



Starsys Overhead Storage Solutions: The Starsys line offers two solutions when additional wall storage is required above a WorkCenter or when overhead storage is required above a Mobile WorkCenter.

Starsys Half-Depth Overhead Storage Units — are built on the same widths as Starsys base units utilizing very similar construction, insuring that wall cabinets align with the lower product configuration in your application. Starsys Overhead Cabinets are available as single or double width cabinets in the following interior heights:

Interior dimensions: 24", 27", 30", 33", 36" [610mm, 686mm, 762mm, 838mm, 914mm] (add 2.5" [64mm] for overall exterior height).

All Starsys overhead cabinets include corrugated polymer inner panels in their assembly as well as a clean-design back panel, molded with the cosmetic side facing the inside of cabinet, creating a much cleaner appearance — especially when used without doors or in conjunction with a clear door. The necessary wall mount rails/hardware are included with each wall cabinet. (wall anchoring hardware is not supplied by InterMetro).

Starsys Carts are built to exact customer specifications, therefore, they are non-cancelable, non-returnable.  
For Starsys pricing information, please contact your local Metro representative.



Cat. No. SXR5OH27P2C



Cat. No. SXR5OH27P2N



Cat. No. SXR5OH27P2S



Cat. No. SXRDOH27P2S



Cat. No. SXRDOH27W2C

### Starsys Wall Cabinet Accessories

| Description   | Cat. No.    |
|---|-------------|
| <b>Wall Cabinet Shelving</b>                                |             |
| Single-wide Overhead Polymer Shelf                          | SXR5OHPS    |
| Single-wide Overhead Wire Shelf                             | SXR5OHWE    |
| Double-wide Overhead Polymer Shelf                          | SXRDOHPS    |
| Double-wide Overhead Wire Shelf                             | SXRDOHWE    |
| <b>Wall Cabinet Shelf Divider Kits</b>                      |             |
| Single-wide Overhead Shelf Divider Kit                      | SXR5OHDIV   |
| Double-wide Overhead Shelf Divider Kit                      | SXRDOHDIV   |
| <b>Under Cabinet Lighting</b>                               |             |
| Single-wide Overhead Light (Valance and 1 Light)            | SXR5OHL     |
| Double-wide Overhead Light (Valance and 1 Light)            | SXRDOHL     |
| Triple-wide Overhead Light (Valance and 2 Lights)           | SXRTOHL     |
| Additional Overhead Light                                   | SXROHLT     |
| <b>Cassettes and Bins</b>                                   |             |
| 1 Level Cassette Body                                       | SXRCASB1    |
| 2 Level Cassette Body                                       | SXRCASB2    |
| 3 Level Cassette Body                                       | SXRCASB3    |
| 4 Level Cassette Body                                       | SXRCASB4    |
| 5 Level Cassette Body                                       | SXRCASB5    |
| 3" (76mm) wide Cassette Bin                                 | SXRBINSB3   |
| 4 1/2" (114mm) wide Cassette Bin                            | SXRBINSB4   |
| 6" (152mm) wide Cassette Bin                                | SXRBINSB6   |
| 8" (203mm) wide Cassette Bin                                | SXRBINSB8   |
| <b>Note:</b> Bins are shipped with one ID card.             |             |
| <b>Sloped Tops — Wall Cabinets</b>                          |             |
| Single-wide Overhead Sloped Top                             | SXR5OHLTOP  |
| Double-wide Overhead Sloped Top                             | SXRDOHSLTOP |
| <b>Filler Kits — Additional Wall Mount Rails and Covers</b> |             |
| 49" (1245mm) Overhead Back Filler Kit                       | SXROHFLR-49 |
| 63" (1600mm) Mounting Rail Cover Kit                        | SXROHFLR-63 |
| Additional Single-wide Wall Mount Bracket Kit (1 Pair)      | SXROHWB-22  |
| Additional Double-wide Wall Mount Bracket Kit (1 Pair)      | SXROHWB-42  |



Wall Cabinets

To configure a Starsys unit to your exact specifications, please visit [www.metroconfigurator.com](http://www.metroconfigurator.com)